

CERTIFIED CORNER RECORDATION

Corner Cor 6 of HES 785 T. 35N R. 25W P.M.M. Lincoln County

1917 HES Original Record by R. E. Maurer:

A small stone mkd. with a cross (X) under a slate stone, 26x14x7 ins., 16 ins. in the ground, mkd. 6 HES 785 on the NE face and a cross (X) on top.
Two Bearing Trees and a mound of earth, 4 ft. base, 2 ft. high, NE of corner.

1960 BLM Resurvey by D. Cunningham:

Found: Slate stone, 26x14x7 ins., set 16 ins. in the ground and mkd. as above.
A Fir, 10 ins. in diam. bears N43 3/4°E, 26 lks. dist., mkd. X 6 HES 785 BT;
A Larch stump, 9 ins. in diam. bears N74°05'W, 18 lks. dist., mkd. X 6 HES 785 BT;
Set an Iron Post, 30 ins. long, 2 1/2 ins. diam., 26 ins. in the ground, with
A Brass Cap mkd as shown.
A Larch, 8 ins. in diam., bears N72°E, 51 lks. dist., mkd. 6 HES 785 BT.
A Fir, 7 ins. in diam., bears S15 1/4°E, 39 lks. dist., mkd. 6 HES 785 BT.
Bury the original stone alongside and raise a mound of stone, 3 ft. base, 2 ft high, NW of IP.

1991 Resurvey by Alvah F. Hughes:

Found A BLM Brass Cap, 3 1/4 ins. diam., flush with ground, with a rock mound, 1 ft. West of corner, mkd. as shown;

A Fir, 16 ins. diam., bears N53°E, 17.7 ft. dist., visible scribing;
A Larch, 13 ins. in diam., bears N72°E, 33.7 ft. dist., healed face.
A Fir, 11 ins. in diam., bears S12°E, 26.2 ft. dist., healed face.

Set:

A galvanized steel guard post, 6 ft. long with LSM & PB decals, bears N46°E, 4 ft. dist.

2. Found BLM Brass Monument, 3 1/4 ins. in diam., flush with ground with mound of stone West, 1 ft. dist. from corner;

A Douglas Fir, 18 ins. in diam., bears N53°E, 17.70 ft. dist., healed face;
A Western Larch, 15 ins. in diam., bears N72°E, 33.70 ft. dist., healed face;
A Douglas Fir, 12 ins. in diam., bears S12°E, 26.20 ft. dist., healed face;
A Steel post, bears N46°E, 4 ft. dist. with LSM & Boundary tags.

3. Stacked and painted a mound of stone around monument.

Repainted blazes and rings on BTs., New BT tag on Douglas Fir, N53°E.

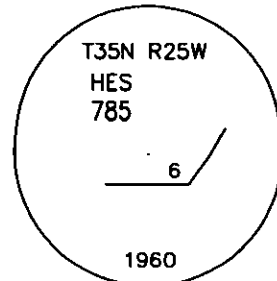

MAGNETIC DECLINATION - 16° EAST

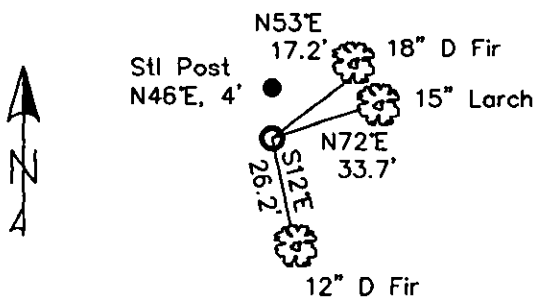

SKETCH OF CORNER

CERTIFICATION

I, CURT HECKROTH
certify the information shown herein is true and correct.

Professional Land Surveyor

I, LAWRENCE A. GLAHE
certify that the Corner Recordation represents work
performed by me or under my supervision in compliance with
the "Corner Recordation Act" (Title 22, Chapter 101, et seq. M.C.A.)

Professional Land Surveyor

Date: 11/16/2010 9748 LS
Employer: GLAHE & ASSOC., INC.

Office of Clerk and Recorder, Courthouse, Lincoln, This "corner
229681 BOOK: CCR CC&R'S PAGE: 11651 Pages: 1 ec. 4
record" was filed for record on STATE OF MONTANA LINCOLN COUNTY
was noted on the cross-index pl RECORDED: 11/16/2010 9:21 KOI: CC&R'S
book No. TAMMY D. LAUER CLERK AND RECORDER
FEE: \$0.00 BY: [Signature]
TO: GLAHE & ASSOC., INC. P.O. BOX 1863, SANDPOINT, ID. 83860,
6 HES 785
Cross Index No. 5026 T. 35N R. 25W PMM

Adopted July 1, 1981, Montana Board of Professional Engineers & Land Surveyors

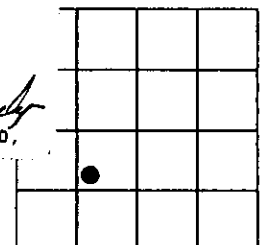

100-443885-1

100

1. *Chlorophyll a* and *Chlorophyll b* were determined by the method of Lichtenthaler and Whistler (1973).

Journal of Management Education 30(6)

[illegible]

1. *Journal of the American Medical Association*, 1997; 277: 1039-1043.