

CERTIFIED CORNER RECORDATION

Corner Cor 5 of HES 785 T. 35N R. 25W P.M.M. Lincoln County

1917 HES Original Record by R. E. Maurer:

A small stone mkd. with a cross (X) under a slate stone, 24x8x8 ins., 14 ins. in the ground, mkd. 5 HES 785 on the NW face and a cross (X) on top.

Two Bearing Trees and a mound of earth, 4 ft. base, 2 ft. high, NW of corner.

1960 BLM Resurvey by D. Cunningham:

Found: Slate stone, 24x8x8 ins., set and mkd. as above.

A Larch, 14 ins. in diam. bears N46°27'E, 13 lks. dist., markings overgrown;

A Fir, 8 ins. in diam. bears S33°53'W, 17 lks. dist., marking overgrown;

Set an Iron Post, 30 ins. long, 2½ ins. diam., 26 ins. in the ground, with

A Brass Cap mkd as shown.

A Fir, 6 ins. in diam., bears N42°W, 20 lks. dist., mkd. 5 HES 785 BT.

Bury the original stone alongside and raise a mound of stone, 3 ft. base, 2 ft high, NW of IP.

1991 Resurvey by Alvah F. Hughes:

Found A BLM Brass Cap, ¾ ins. diam., 3 ins. out of the ground, with a rock mound, 1 ft. NW of corner, mkd. as shown;

A Larch, 18 ins. diam., bears N46°E, 9.0 ft. dist., visible scribing;

A Fir, 12 ins. in diam., bears S33°W, 11.1 ft. dist., healed face.

A Fir, 9 ins. in diam., bears N44°E, 13.7 ft. dist., healed face.

Set:

A galvanized steel guard post, 6 ft. long with LSM & PB decals, bears North, 3 ft. dist.

2. Found:

A BLM Brass monument, ¾ ins. in diam., 3 ins. out of ground with a stone mound NW, 1 ft. dist. from corner;

A Western Larch, 19 ins. in diam., bears N46°E, 9.0 ft. dist., healed face;

A Douglas Fir, 14 ins. in diam., bears S33°W, 11.10 ft. dist., healed face;

A Douglas Fir, 10 ins. in diam., bears N44°E, 13.70 ft. dist., healed face;

A Steel post, bears North, 3 ft. dist. with LSM & Boundary tags.

3. Stacked and painted a mound of stones around monument.

Repainted blazes and rings on BTs.

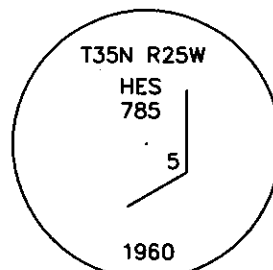

MAGNETIC DECLINATION - 16° EAST

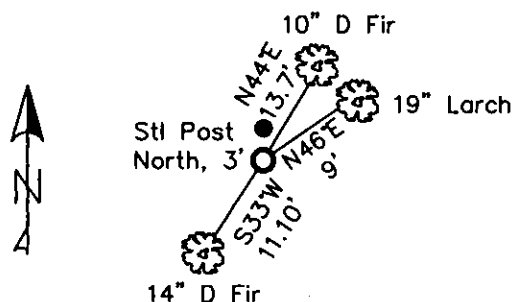

SKETCH OF CORNER

CERTIFICATION

I, CURT HECKROTH
 certify the information shown above is true and correct.

Curt Heckroth

I, LAWRENCE A. GLAHE
 certify that this Corner Record represents work performed by me or under my direction in compliance with the "Corner Recordation Act" (Title 22, Chapter 101, et seq. M.C.A.)

Lawrence A. Glahe

Date: 11/16/10 9748 LS

Employer: GLAHE & ASSOC., INC.

Office of Clerk and Recorder, County of Lincoln. This "corner record" was filed for record on 229680 BOOK: CCR CC&R'S PAGE: 11650 Pages: 1

was noted on the cross-index STATE OF MONTANA LINCOLN COUNTY

book No. TAMMY D. LAUER CLERK AND RECORDER

FEE: \$0.00 BY: *Tammy D. Lauer*

TO: GLAHE & ASSOC., INC. P.O. BOX 1863, SANDPOINT, ID. 83860,

5 HES 785

Cross Index No. 5027 T. 35N R. 25W PMM

Adopted July 1, 1981, Montana Board of Professional Engineers & Land Surveyors

Sec. 4

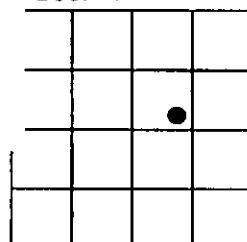

● corner this sheet

