

CERTIFIED CORNER RECORDATION

Corner Cor 3 of HES 787 T. 35N R. 25W P.M.M. Lincoln County

1. 1917 HES Original record by R.E. Maurer:

Set:

- A small stone, marked with a cross (X) under a sandstone 30x8x6 ins.; 20 ins. in the ground, marked 3 H.E.S. 787 on the SE face and a cross on top for the exact corner point. From which:
- A Fir, 5 ins. in diam. bears S65°57'W, 42 lks. dist. mkd. with X and scribed 3 HES 787 BT;
- A Fir, 5 ins. in diam. bears S2°09'E, 83 lks. dist. mkd. with X and scribed 3 HES 787 BT;
- A mound of earth 4 ft. base, 2 ft. high, SE of corner.

1991 Resurvey by Alvah F. Hughes:

Found:

- A Stone, 20x7x6 ins., firmly set in ground, mkd. 3 HES 787 on SW face (Stone fractured)
- A small Sandstone with chiseled X and fragments of cor. stone while excavating for the new monument.

A Rotten Root Crown, bears S67°W, 25.1 ft. dist. (38 lks.)

Set: an Aluminum Pipe, 30 ins. long, 2½ ins. diam., 26 ins. in the ground, with a 3¼ in. Alum. Cap mkd as shown.

Established:

- A Fir, 19 ins. in diam. bears N72°E, 37.3 ft. dist., mkd. 3 HES 787 BT;
- A Fir, 16 ins. in diam. bears N1°W, 28.2 ft. dist., mkd. 3 HES 787 BT.
- A Steel guard post with LSM and BT signs, bears East, 3 ft. dist.
- Buried the old corner stone alongside and raised a collar of stone around monument.

2. Found:

- A USDA Aluminum monument, 3¼ ins. in diam., 6 ins. out of ground surrounded by a mound of stone, mkd. as shown;
- A Douglas Fir, 20 ins. in diam., bears N72°E, 37.30 ft. dist., with a well healed face;
- A Douglas Fir, 18 ins. in diam., bears N1°W, 28.20 ft. dist., with a well healed face;
- A Steel post, bears East, 3 ft. dist.
- A Wood post, 4 ins. x 4 ins., bears South, 12 ft. dist. with Boundary and Location tag.

3. Stacked and painted a mound of stone around monument.
Repainted blazes and rings on all BTs.

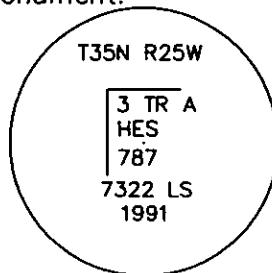

MAGNETIC DECLINATION - 16° EAST

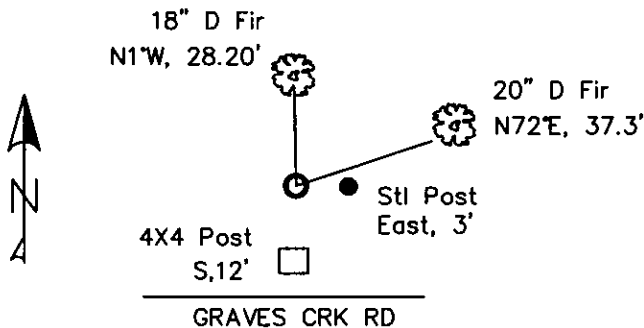

SKETCH OF CORNER

CERTIFICATION

I, CURT HECKROTH
certify the information shown herein to be true and correct.
Curt Heckroth
Signature Ground Party Clerk

I, LAWRENCE A. GLAHE
certify that the Corner Record furnished represents work performed by me or under my direction in compliance with the "Corner Recordation Act" (P.L. 86-224-101, et seq. M.C.A.)
Alvah F. Hughes
Signature Registered Surveyor

Date: 11-10-10 9748 LS
Employer: GLAHE & ASSOC., INC.

Office of Clerk and Recorder... County of Lincoln This "corner
229650 BOOK: CCR CCR'S PAGE: 11634 Pages: 1
record" was filed for r STATE OF MONTANA LINCOLN COUNTY
was noted on the cro: TAMMY D. LAUER CLERK AND RECORDER
book No. _____ FEE: \$0.00 BY: *Alvah F. Hughes*
TO: GLAHE & ASSOC., INC. P.O. BOX 1863, SANDPOINT, ID. 83860,

3 HES 787

Cross Index No. 5007 T. 35N R. 25W PMM

Adopted July 1, 1981, Montana Board of Professional Engineers & Land Surveyors

Sec. 6

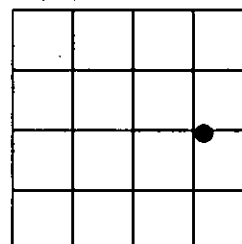

● corner this sheet

