

CERTIFIED CORNER RECORDATION

Corner CW Sec 7 T. 35N R. 25W P.M.M. Lincoln County

Found:

A 5/8 ins. rebar with yellow plastic cap by LS 13102. Bears S79°W, .75 ft out of correct position, drove rebar below ground surface, the original E 1/4 was found this survey.

Set:

A USFS Aluminum Monument, 3 1/4 ins. in diam., on 5/8 ins. diam. rebar, mkd. as shown;
A Douglas Fir, 15 ins. in diam., bears N81°E, 18.2 ft. dist. scribed "CW 1/16 S7 BT";
A Larch, 14 ins. in diam., bears S52°E, 22.8 ft. dist., scribed "CW 1/16 S7 BT";
Steel posts with decals, bear North, 2.5 ft. dist. and East, 2.0 ft. dist.



MAGNETIC DECLINATION - 15°4' EAST

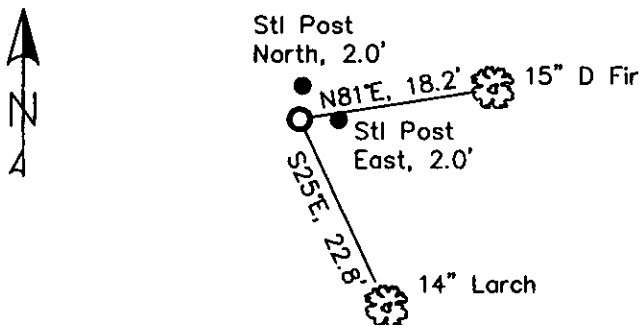

CERTIFICATION

I, Erich Shrack
certify the information stated herein is true and correct.
I, LAWRENCE A. GLAHE
certify that this Corner Recordation was performed by me or under my direct supervision in compliance with the "Corner Recordation Act" (Pub. Law 86-401, et seq. U.S.C.A.)
Date: 11-10-10
Employer: GLAHE & ASSOC., INC.

SKETCH OF CORNER

Office of Clerk and Recorder, County of Lincoln. This "corner

record" was filed for record

was noted on the cross-index

book No. _____

229648 BOOK: CCR CCR'S PAGE: 11632 Pages: 1
STATE OF MONTANA LINCOLN COUNTY
RECORDED: 11/15/2010 1:27 KOI: CCR'S
TAMMY D. LAUER CLERK AND RECORDER
FEE: \$0.00 BY: Francis Lauer
TO: GLAHE & ASSOC., INC. P.O. BOX 1863, SANDPOINT, ID. 83860

Cross Index No. G-2 T. 35N R. 25W PMM

Adopted July 1, 1981, Montana Board of Professional Engineers & Land Surveyors

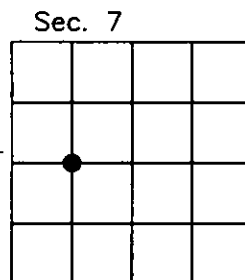

● corner this sheet

THE UNIVERSITY OF CHICAGO
LIBRARY

THE UNIVERSITY OF CHICAGO
LIBRARY

THE UNIVERSITY OF CHICAGO
LIBRARY

THE UNIVERSITY OF CHICAGO
LIBRARY

THE UNIVERSITY OF CHICAGO
LIBRARY