

CERTIFIED CORNER RECORDATION

Corner C-W-W-NE 256th S29 T. 35N R. 25W P.M.M. Lincoln County

1. Original GLO Notes:

Set:

This corner was never set.

1982 M.L. Haiges:

Set:

An Aluminum Monument with $3\frac{1}{4}$ ins. dia. cap, 24 ins. in the ground, with protective ring of stone;

From which:

A Larch, 8 ins. in diam., bears S70°E, 35.3 ft. dist., scribed "CWWNE 1/256 BT";

A Larch, 8 ins. in diam., bears S19°W, 29.3 ft. dist., scribed "CWWNE 1/256 BT".

2. Found:

A USDA Aluminum monument, with cap $3\frac{1}{4}$ ins. in diam., 4 ins. out of ground, surrounded by a mound of stone, mkd. as shown;

A Western Larch, 9 ins. in diam., bears S70°E, 35.30 ft. dist., healed face;

A Western Larch dying, 9 ins. in diam., bears S19°W, 29.30 ft. dist., open face, W NE 1/256 BT visible;

A Carsonite Post, with boundary sign, bears West, 6.40 ft. dist.

3. Established:

A Western Larch, 11 ins. in diam., bears S14°E, 7 ft. dist., scribed C-W-W-NE 1/256 S29 BT.

Restacked and painted stones around monument; Repainted blazes and rings on all BTs.

Placed Steel Post with LSM & Boundary tags in front of carsonite post, bears West, 6.40 ft. dist.

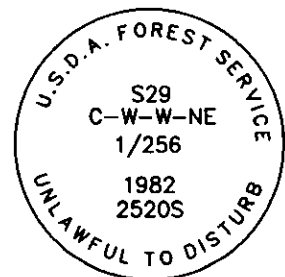

MAGNETIC DECLINATION - 16° EAST

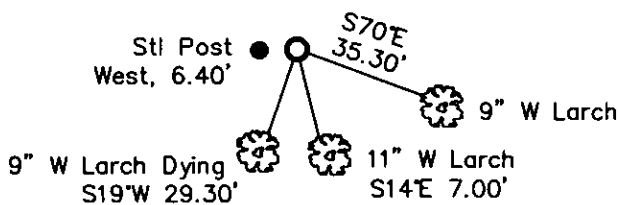
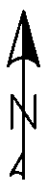

SKETCH OF CORNER

CERTIFICATION

I, CURT HECKROTH

certify the information shown herein is true and correct.

Curt Heckroth
Signature of Ground Party

I, LAWRENCE A. GLAHE

certify that this Corner Recordation represents work performed by me or under my supervision in compliance with the "Corner Recordation Act" (78-12-101, et seq. M.C.A.)

Lawrence A. Glahe
9748 LS
REGISTERED LAND SURVEYOR
Date: _____
Employer: GLAHE & ASSOC., INC.

Office of Clerk and Recorder, County of Lincoln. This "corner

record" was filed for 229637 BOOK: CCR CC&R'S PAGE: 11621 Pages: 1

STATE OF MONTANA LINCOLN COUNTY

was noted on the cr RECORDED: 11/15/2010 1:16 KOI: CC&R'S

book No. TAMMY D. LAUER CLERK AND RECORDER

FEE: \$0.00

BY: *Lawrence A. Glahe*

TO: GLAHE & ASSOC., INC. P.O. BOX 1863, SANDPOINT, ID. 83860

Cross Index No. S-7.25 T. 35N R. 25W PMM

Adopted July 1, 1981, Montana Board of Professional Engineers & Land Surveyors

Sec. 29

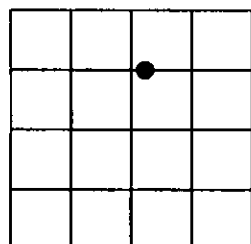

● corner this sheet

10

11

12

13

14

15

16

17

18

19

20

21

22

23

24

25

26

27

28

29

30

31

32

33

34

35

36

37

38

39

40

41

42

43

44

45