

# CERTIFIED CORNER RECORDATION

Corner CW 16th S32 T. 35N R. 25W P.M.M. Lincoln County

1. Original GLO Notes:  
THIS CORNER WAS NEVER SET.

## 1982 M.L. HAIGES:

Set:

An Alum. Monument, 2½ ins. x 30 ins. with ¾ ins. cap, 24 ins. in the ground, with a protective ring of stone:

From which:

A Larch, 8 ins. in diam., bears S21°W, 70.9 ft. dist., scribed CW 1/16 BT;

A Fir, 7 ins. in diam., bears S76°W, 75.0 ft. dist., scribed CW 1/16 BT;

2. Found:

A USDA Aluminum monument, with cap ¾ ins. in diam., 6 ins. out of ground, surrounded by a mound of stone, mkd. as shown;

A Western Larch, 10 ins. in diam., bears S21°W, 70.90 ft. dist., healed face;

A Douglas Fir, 9 ins. in diam., bears S76°W, 75.00 ft. dist., healed face;

A Carsonite Post, broken off, bears South, 3.50 ft. dist.

3. Restacked and painted stones around monument; Repainted blazes and rings on all BTs. Placed BT tag on S76°W BT. Placed Steel Post with LSM & Boundary tags in front of broken carsonite post, bears South, 3.50 ft. dist.

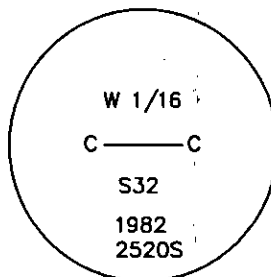

MAGNETIC DECLINATION - 16° EAST

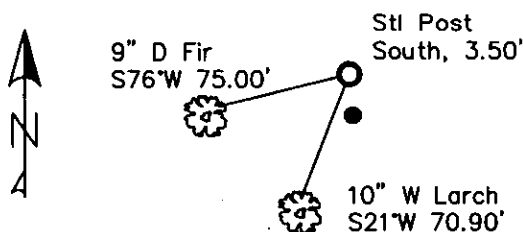

SKETCH OF CORNER

CERTIFICATION

I, CURT HECKROTH  
certify the information shown herein is true and correct.  
*Curt Heckroth*  
Signature, Ground Party, Clerk

I, LAWRENCE A. GLAHE  
certify that this Corner was set or re-established in compliance with the "Corner Restoration Act" (Pub. Law 92-401, et seq. M.C.A.)  
*Lawrence A. Glahe*  
Signature, Registered Professional Engineer and Land Surveyor  
Date: 11-10-12 9748 LS  
Employer: GLAHE & ASSOCIATES, INC.

Office of Clerk and Recorder, County of Lincoln. This "corner

record" was filed for record 229631 BOOK: CCR CC&R'S PAGE: 11616 Pages: 1

was noted on the cross-index STATE OF MONTANA LINCOLN COUNTY

book No.                      RECORDED: 11/15/2010 11:45 KOI: CC&R'S

TAMMY D. LAUER CLERK AND RECORDER  
FEE: \$0.00 BY: *Tammy D. Lauer*  
TO: GLAHE & ASSOC., INC. P.O. BOX 1863, SANDPOINT, ID. 83860,  
Cross Index No. X-6 T. 35N R. 25W PMM

Adopted July 1, 1981, Montana Board of Professional Engineers & Land Surveyors

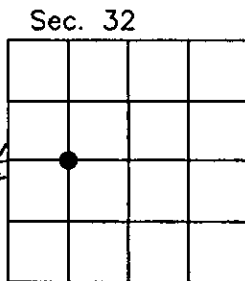

● corner this sheet

1. The first part of the report is a general introduction to the subject of the study.

2. The second part of the report is a detailed description of the methods used in the study.

3. The third part of the report is a discussion of the results of the study.

4. The fourth part of the report is a conclusion and a list of references.

5. The fifth part of the report is a list of appendices.

6. The sixth part of the report is a list of figures and tables.

7. The seventh part of the report is a list of footnotes.

8. The eighth part of the report is a list of references.

9. The ninth part of the report is a list of appendices.

10. The tenth part of the report is a list of figures and tables.

11. The eleventh part of the report is a list of footnotes.

12. The twelfth part of the report is a list of references.

13. The thirteenth part of the report is a list of appendices.

14. The fourteenth part of the report is a list of figures and tables.

15. The fifteenth part of the report is a list of footnotes.

16. The sixteenth part of the report is a list of references.

17. The seventeenth part of the report is a list of appendices.

18. The eighteenth part of the report is a list of figures and tables.

19. The nineteenth part of the report is a list of footnotes.

20. The twentieth part of the report is a list of references.

21. The twenty-first part of the report is a list of appendices.

22. The twenty-second part of the report is a list of figures and tables.

23. The twenty-third part of the report is a list of footnotes.

24. The twenty-fourth part of the report is a list of references.