

CERTIFIED CORNER RECORDATION

Corner C-W-E-E 1/256th S32 T. 35N R. 25W P.M.M. Lincoln County

1. Original GLO Notes:
THIS CORNER WAS NEVER SET.

1982 M.L. HAIGES:

Set:

An Alum. Monument, 2½ ins. x 30" with ¾ ins. cap, 24 ins. in the ground, with a protective ring of stone:

From which:

A Spruce, 7 ins. in diam., bears S83°E, 49.0 ft. dist., scribed CWEE 1/256 BT;

A Spruce, 6 ins. in diam., bears S02°E, 39.5 ft. dist., CWEE 1/256 BT;

2. Found:

A USDA Aluminum monument, ¾ ins. in diam., 6 ins. out of ground surrounded by a mound of stone, mkd. as shown;

A Spruce, 12 ins. in diam., bears S83°E, 49.00 ft. dist., healed face;

A Spruce, 11 ins. in diam., bears S02°E, 39.50 ft. dist., healed face;

A Carsonite post with LSM and Boundary tags bears East, 4.50 ft. dist.

3. Restacked and painted stones around monument. Repainted blazes and rings on all BTs.

Placed new BT tags. Placed Steel post with LSM and Boundary tags in front of carsonite post bears East, 4.50 ft. dist.

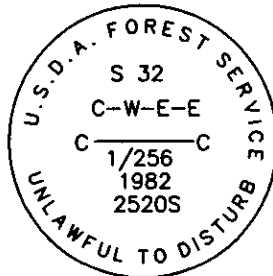

MAGNETIC DECLINATION - 16° EAST

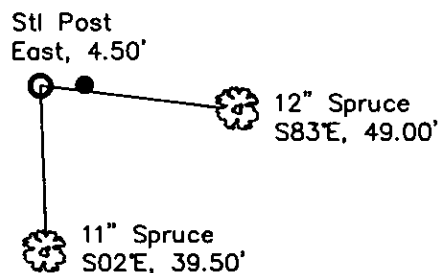
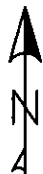

SKETCH OF CORNER

CERTIFICATION

1. CURT HECKROTH

certify the information shown herein as true and correct.

Lawrence A. Glahe
Signature of Surveyor

2. LAWRENCE A. GLAHE

certify that this Corner Recordation was performed by me or under my direction in compliance with the "Corner Recordation Act" (No. 22-101, et seq. M.C.A.)

9748 LS

REGISTERED

NO. 9748 LS

Date: 11-10-10

Employer: GLAHE & ASSOC., INC.

9748 LS

Office of Clerk and Recorder, County of Lincoln. This "corner

record" was filed for rec 229627 BOOK: CCR CC&R'S PAGE: 11612 Pages: 1

STATE OF MONTANA LINCOLN COUNTY

was noted on the cross: RECORDED: 11/15/2010 11:41 KOI: CC&R'S

book No. TAMMY D. LAUER CLERK AND RECORDER

FEE: \$0.00

TO: GLAHE & ASSOC., INC. P.O. BOX 1863, SANDPOINT, ID. 83860,

Cross Index No. X-8 T. 35N R. 25W PMM

Adopted July 1, 1981, Montana Board of Professional Engineers & Land Surveyors

Sec. 32

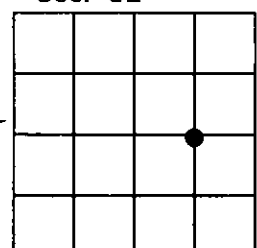

● corner this sheet

Journal of Management Education 30(6)

[illegible]

1. *Chlorophyll a* and *Chlorophyll b* were determined by the method of Arar and Collins (1971) using a Shimadzu 1601 UV-Visible Spectrophotometer. The concentration of chlorophyll was expressed in $\mu\text{g mL}^{-1}$.