

CERTIFIED CORNER RECORDATION

Corner E 1/4 Cor S32 T. 35N R. 25W P.M.M. Lincoln County

1. Original GLO Notes:

Set:

A Limestone, 12x8x6, 8 ins. in the ground for cor. mkd. 1/4 on W. face;

From which:

A Tamarack, 14 ins. in diam., bears S82°45'E, 30 lks. dist., mkd. 1/4 S BT;

A Tamarack, 38 ins. in diam., bears S70°W, 53 lks. dist. mkd. 1/4 S BT

BLM Record:

Original Bearing Trees:

A Larch stump, 17 ins. in diam., bears S82°E, 30 lks. dist., markings illegible;

A Larch stump, 38 ins. in diam. bears S70°W, 53 lks. dist., markings illegible.

Set:

An Iron Post, 30 ins. long, 2 1/2 ins. diam., 26 ins. in the ground, in concrete with

A Brass Cap mkd as shown, determined at record bearing and distance from remains of original BTs:

A Fir, 4 ins. in diam., bears N81 3/4°E, 55 lks. dist., mkd. 1/4 S33 BT;

A Fir, 7 ins. in diam., bears S28°W, 25 lks. dist., mkd. 1/4 S32 BT;

1982 James H. Burton:

Found:

A BLM Brass Cap Monument as described above,

From which:

A Fir, 11 ins. in diam., bears N82°E, 36.6 ft. dist., with scribing;

A Stump, 16 ins. in diam., bears S87°E, 19.7 ft. dist., with scribing;

A Fir, 9 ins. in diam., bears S28°W, 16.5 ft. dist., with overgrown blaze;

A Stump, 30 ins. in diam., bears S71°W, 34.6 ft. dist. with scribing.

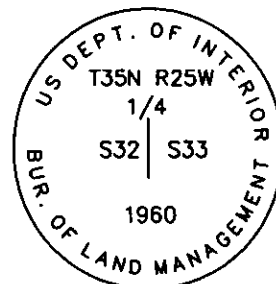

2. Found:

A BLM Brass Monument, 3 1/4 in. in diam., 4 ins. out of ground surrounded by a mound of stone, mkd. as shown;

A Douglas Fir, 18 ins. in diam., bears N82°E, 36.60 ft. dist., healed face;

A Rotted Stump remains, bears S87°E, 19.70 ft. dist., no scribing;

A Douglas Fir, 15 ins. in diam., bears S28°W, 16.50 ft. dist., healed face;

A Stump, 28 ins. in diam., bears S71°W, 34.60 ft. dist., BT visible;

A Carsonite post with LSM and Boundary tags, bears West, 8 ft. dist.

3. Restacked and painted stones around monument. Repainted blazes and rings on all BTs. Placed new BT tags. Placed Steel Post with LSM and Boundary tags, in front of carsonite post, bears West, 8 ft. dist.

MAGNETIC DECLINATION - 16° EAST

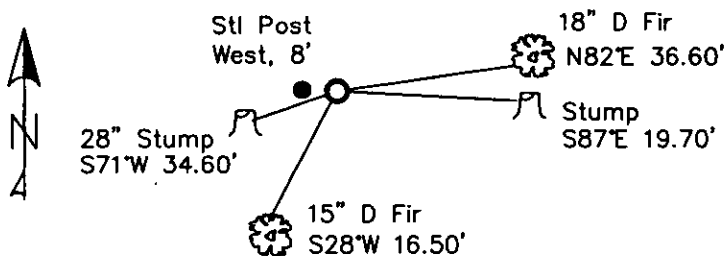

SKETCH OF CORNER

CERTIFICATION

I, CURT HECKROTH
certify the information shown herein is true and correct.

Curt Heckroth
Signature Ground Party, Owner

I, LAWRENCE A. GLAHE
certify that this Corner Location represents work performed by me or under my direction in compliance with the "Corner Recordation Act" (Pub. Law 96-354, et seq. U.S.C.A.)

Lawrence A. Glahe
Signature Registered Professional Surveyor

Date: 11-15-2010 9748 LS

Employer: GLAHE & ASSOC., INC.

Office of Clerk and Recorder, County of Lincoln. This "corner

record" was filed for record

229626 BOOK: CCR CC&R'S PAGE: 11611 Pages: 1

Sec. 32

was noted on the cross-index

STATE OF MONTANA LINCOLN COUNTY

book No. _____

RECORDED: 11/15/2010 11:40 KOI: CC&R'S

TAMMY D. LAUER CLERK AND RECORDER

FEE: \$0.00

TO: GLAHE & ASSOC., INC. P.O. BOX 1863, SANDPOINT, ID. 83860,

Cross Index No. X-9 T. 35N R. 25W PMM

Adopted July 1, 1981, Montana Board of Professional Engineers & Land Surveyors

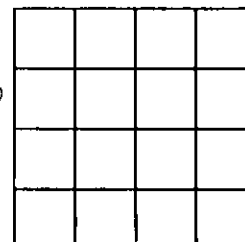

● corner this sheet

[illegible]

the 1990s, the number of people in the world who are under 15 years of age is expected to increase from 1.1 billion to 1.5 billion. The number of people aged 65 and over is expected to increase from 200 million to 400 million. The number of people aged 15 and over is expected to increase from 3.5 billion to 4.5 billion. The number of people aged 15 and over is expected to increase from 3.5 billion to 4.5 billion. The number of people aged 15 and over is expected to increase from 3.5 billion to 4.5 billion.

— *Journal of the American Medical Association*, 1991

Chrysomelidae

1. *Chlorophyll a* and *Chlorophyll b* were determined by the method of Arar and Collins (1971) using a Shimadzu 1010 spectrophotometer. The concentration of chlorophyll was expressed in $\mu\text{g mL}^{-1}$ of the sample.

... ..