

# CERTIFIED CORNER RECORDATION

Corner C-W-E-NW S20 T. 35N R. 25W P.M.M. Lincoln County

## 1. 1980 CLC by Thomas C. Hill 5612S:

Found: No previous record of corner establishment on file.

Set:

A Cap on a 2½ ins. x 30 ins. alum. pipe, 24 ins. in the ground, with a collar of stone and mkd. as shown;

A Douglas Fir, 9 ins. in diam. bears S23°W, 6.4 ft. dist. mkd. X BT;

A Douglas Fir, 13 ins. in diam. bears N29°E, 40.6 ft. dist., mkd. 1/256 S20 BT;

Attached a Location poster to a Douglas Fir, 22 ins. in diam. bears N18°W, 29.1 ft. dist.

## 2. Found:

A USDA Aluminum monument, 3¼ ins. diam. cap, 6 ins. out of ground, mkd. as shown;

A Douglas Fir, 19 ins. in diam., bears N29°E, 40.60 ft. dist., healed face;

A Douglas Fir, 14 ins. in diam., bears S23°W, 6.40 ft. dist., healed face;

A Douglas Fir, 26 ins. in diam., bears N8°W (record N18°W), 29.10 ft. dist., with unreadable Location tag;

A Steel post with LSM & Boundary tag, bears West, 3 ft. dist.;

A Steel T-post bears N44°W, 21.50 ft. dist.

## 3. Stacked and painted a mound of stones around monument;

Repainted blazes and rings on all BTs; Placed BT tag on N29°E BT and

Location tag on 26" D Fir.

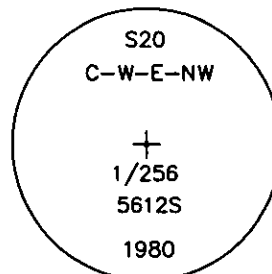

MAGNETIC DECLINATION - 16° EAST

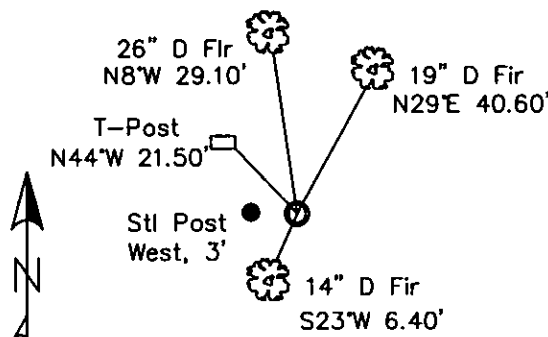

SKETCH OF CORNER

CERTIFICATION

I, CURT HECKROTH  
 certify the information shown herein is true and correct.

*Curt Heckroth*  
 Signature Ground Party-File

I, LAWRENCE A. GLAHE  
 certify that this Corner Location Record represents work performed by me or under my direction in compliance with the "Corner Registration Act" (MCA 22-1-01, et seq. M.C.A.)

*Lawrence A. Glahe*  
 Signature Registered Professional Engineer and Land Surveyor

Date: 11-10-10 9748 LS

Employer: GLAHE & ASSOC., INC.

Office of Clerk and Recorder, County of Lincoln. This "corner

record" was filed for re 229609 BOOK: CCR CC&R'S PAGE: 11594 Pages: 1

was noted on the cross STATE OF MONTANA LINCOLN COUNTY  
RECORDED: 11/15/2010 11:21 KOI: CC&R'S

book No. TAMMY D. LAUER CLERK AND RECORDER

FEE: \$0.00

BY:

TO: GLAHE & ASSOC., INC. P.O. BOX 1863, SANDPOINT, ID. 83860,

Cross Index No. 0-6.25 T. 35N R. 25W PMM

Adopted July 1, 1981, Montana Board of Professional Engineers & Land Surveyors

Sec. 20

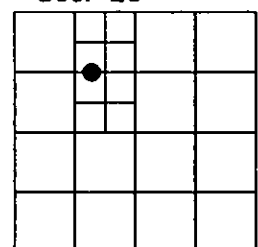

● corner this sheet

