

CERTIFIED CORNER RECORDATION

Corner CE 16th S18 T. 35N R. 25W P.M.M. Lincoln County

1. 1980 CLC by Thomas C. Hill 5612S:

Found: No previous record of corner establishment on file.

Set:

- An Alum Cap on a 2½ ins. x 30 ins. alum. pipe, 25 ins. in the ground, collar of stone and mkd. as shown;
- A Douglas Fir, 7 ins. in diam. bears N40°W, 12.0 ft. dist. mkd. X BT;
- A Douglas Fir, 8 ins. in diam. bears S20°E, 6.5 ft. dist., mkd. CE 1/16 S18 BT;
- Attached a Location poster to a Douglas Fir, 4 ins. in diam. bears N73°E, 2.2 ft. dist.

2. Found:

- A USDA Aluminum Monument, 3¼ ins. cap, 5 ins. out of ground surrounded by a mound of stone, mkd. as shown;
- A Douglas Fir, 11 ins. in diam., bears S20°E, 6.50 ft. dist., healed face;
- A Douglas Fir, 9 ins. in diam., bears N40°W, 12.00 ft. dist., healed face;
- A Douglas Fir, 8 ins. in diam., bears N73°E, 2.20 ft. dist., with a location tag.
- A Carsonite Post with LSM & Boundary tags, bears South, 7 ft. dist.;
- A metal T-Post, bears N58°W, 4 ft. dist.

3. Restacked and painted stones around monument;

- Repainted blazes and rings on all BTs; placed BT tags on both BTs without;
- Placed Steel Post with LSM & Boundary tags in front of carsonite post, South, 7 ft. dist.

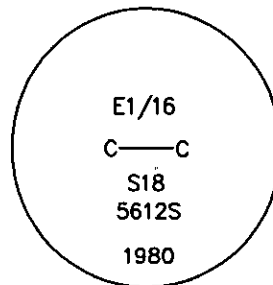

MAGNETIC DECLINATION — 16° EAST

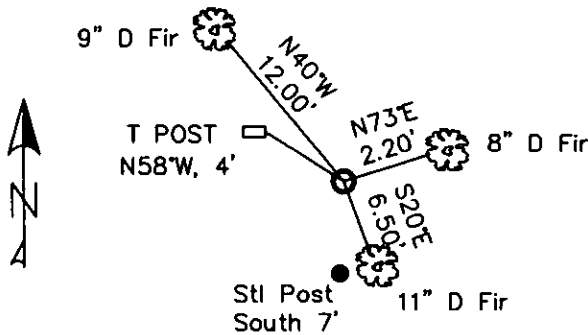

SKETCH OF CORNER

CERTIFICATION

I, CURT HECKROTH
 certify the information shown herein is true and correct.

I, LAWRENCE A. GLAHE
 certify that the Corner Recordation was performed by me or under my direction in compliance with the "Corner Recordation Act" (Mont. Code Annotated, § 82-2-101, et seq. (M.C.A.))

Date: 11/15/2010 9748 LS
 Registered Professional Surveyor
 Employer: GLAHE & ASSOC., INC.

Office of Clerk and Recorder, County of Lincoln. This "corner

record" was filed for record

229605 BOOK: CCR CC&R'S PAGE: 11590 Pages: 1

Sec. 18

was noted on the cross-index

STATE OF MONTANA LINCOLN COUNTY

RECORDED: 11/15/2010 11:17 KOI: CC&R'S

book No. _____

TAMMY D. LAUER CLERK AND RECORDER

FEE: \$0.00

BY: Glennie K. Kinn

TO: GLAHE & ASSOC., INC. P.O. BOX 1863, SANDPOINT, ID. 83860,

Cross Index No. L-4 T. 35N R. 25W PMM

Adopted July 1, 1981, Montana Board of Professional Engineers & Land Surveyors

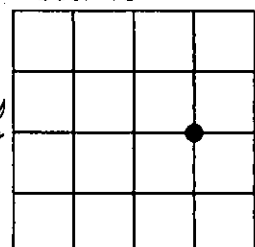

● corner this sheet

THE UNIVERSITY OF CHICAGO
DIVISION OF THE PHYSICAL SCIENCES
DEPARTMENT OF CHEMISTRY

RESEARCH REPORT
NO. 1000
PUBLISHED BY THE UNIVERSITY OF CHICAGO PRESS
CHICAGO, ILLINOIS
1955

RECEIVED
JAN 10 1956
LIBRARY OF THE
UNIVERSITY OF CHICAGO