

CERTIFIED CORNER RECORDATION

Corner C $\frac{1}{4}$ of S18 T. 35N R. 25W P.M.M. Lincoln County

1. 1980 CLC by Thomas C. Hill 5612S:

Found:

An unrecorded 5/8 ins. diam. rebar with a plastic cap stamped "2989 ES" in the position of the C $\frac{1}{4}$ Sec. 18.

A Steel fence post marking approximate corner position bears N09°E, 3.2 ft. dist.

Set:

An Alum Cap on a 2 $\frac{1}{2}$ ins. x 30 ins. alum. pipe, 27 ins. in the ground, mkd. as shown;

A Douglas Fir, 9 ins. in diam. bears N45°E, 22.3 ft. mkd. X BT;

A Douglas Fir, 9 ins. in diam. bears N55°W, 22.6, mkd. C $\frac{1}{4}$ S18 BT;

Attached a Location poster to a Douglas Fir, 8 ins. in diam. bears N16°W, 7.5 ft. dist.

Painted red bands around bearing trees.

2. Found:

A USDA Aluminum monument, 3 $\frac{1}{4}$ ins. cap, 3 ins. out of the ground, surrounded by a mound of stone mkd. as shown;

A Douglas Fir, 13 ins. in diam., bears N45°E, 22.30 ft. dist., healed face;

A Douglas Fir, 12 ins. in diam., bears N55°W, 22.60 ft. dist., healed face;

A Douglas Fir, 11 ins. in diam., bears N16°W, 7.50 ft. dist. with location tag;

A Carsonite Post with boundary tag bears NE, 1.50 ft. dist.;

A Wood Fence corner, 6 ins. in diam., bears East, 2 ft. dist.

3. Repainted stones around monument;

Repainted blazes and rings on all BTs; placed new BT tags to 2 BTs without;

Placed Steel Post with LSM & Boundary tags in front of carsonite post, NE, 2 ft. dist.

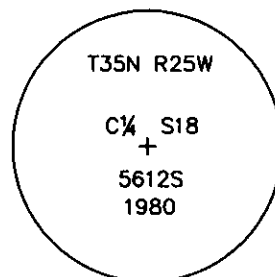

MAGNETIC DECLINATION - 16° EAST

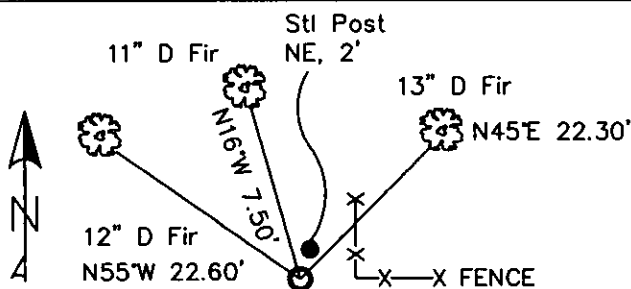

SKETCH OF CORNER

CERTIFICATION

I, CURT HECKROTH
certify the information shown above is true and correct.

I, LAWRENCE A. GLAHE
certify that this Corner Record Book represents work performed by me or under my direction in compliance with the "Corner Recordation Act" (MCA 22-1-101, et seq. (M.C.A.))

Date: 11/10/10 9748 LS
Employer: GLAHE & ASSOC., INC.

Office of Clerk and Recorder, County of Lincoln. This "corner

record" was filed for record on

229604 BOOK: CCR CC&R'S PAGE: 11589 Pages: 1

Sec. 18

was noted on the cross-index

STATE OF MONTANA LINCOLN COUNTY

RECORDED: 11/15/2010 11:16 KOI: CC&R'S

book No. _____

TAMMY D. LAUER CLERK AND RECORDER

FEE: \$0.00

BY: Laurie D. Lauer

TO: GLAHE & ASSOC., INC. P.O. BOX 1863, SANDPOINT, ID. 83860,

Cross Index No. L-3 T. 35N R. 25W PMM

Adopted July 1, 1981, Montana Board of Professional Engineers & Land Surveyors

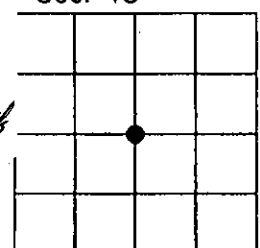

● corner this sheet

THE UNIVERSITY OF CHICAGO

DEPARTMENT OF THE HISTORY OF ARTS

OFFICE OF THE DEAN

1100 EAST 58TH STREET, CHICAGO, ILLINOIS 60637

TEL: 773-936-5000 FAX: 773-936-5001

WWW.HISTORYOFARTS.ORG

CHICAGO, ILLINOIS 60637

CHICAGO, ILLINOIS 60637

CHICAGO, ILLINOIS 60637

CHICAGO, ILLINOIS 60637

CHICAGO, ILLINOIS 60637

CHICAGO, ILLINOIS 60637

CHICAGO, ILLINOIS 60637

CHICAGO, ILLINOIS 60637

CHICAGO, ILLINOIS 60637

CHICAGO, ILLINOIS 60637

CHICAGO, ILLINOIS 60637