

## INSTRUCTIONS

1. Original and/or subsequent record used to evaluate the corner position.
2. Description of evidence found, note discrepancies in the record, state method of establishing lost or obliterated corners.
3. Description of monument and accessories set to perpetuate the corner position.
4. Sketch of corner, show all pertinent data which can best be shown in a sketch example, corner marking, topography ties, position of accessories, etc.
5. Certification must be signed and sealed by Land Surveyor registered in the State of Montana.
6. Fill in Cross Index & Section Diagram at bottom of sheet.

## CERTIFIED CORNER RECORDATION

Corner 5 of HES 1071 T. 35 N. R. 33 W. P.M.M. Lincoln County

- I. 1921 H.E.S. original record by Grant Higgins: "Placed a small stone, marked with a cross (x) under a sandstone, 24x12x6 ins., 14 ins. in the ground, marked 5 HES 1071 on NW face and a cross (x) on top for the exact corner point, from which,
- A cross (x) on a cedar tree, 18 ins. dia., bears  $S75^{\circ}09'W$ , 49 lks. (32.34 ft.) dist.
- A cross (x) on a spruce tree, 4 ins. dia., bears  $S20^{\circ}57'W$ , 59 lks. (38.94 ft.) dist.
- Each blazed and scribed 5 HES 1071 BT.

Raise a mound of stone, 4 ft. base, 2 ft. high, NW of corner."

1976 C.O.S. No. 230 record by Melvin D. Lauteren, Reg. No. 4232-S: "Set 1/2" pipe tagged W & R 4232S"

1981 C.O.S. No. 1283 record by Melvin D. Lauteren, Reg. No. 4232-S: "Found as noted: "HES Corner No. 5, 1/2" pipe W & R 4232-S".

- II. Found a 24x12x6 ins. stone, mkd. 5 HES 1071, laying loose on the surface of the ground. No evidence of the original bearing trees was found. No evidence found of record 1/2 inch pipe set by #4232S as per Certificate of Survey 230.

- III. Corner No. 5 was considered lost and therefore reestablished by the Grant Boundary adjustment between found corners No. 4 and 6, HES 1071. Corner positions as shown are based upon a closed traverse, performed with a total station instrument. At the computed position I set a 2 1/2 in. diam. by 30 in. long alum. pipe 24 ins. in the ground with alum. cap mkd. as shown.

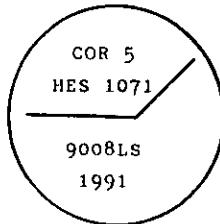

Bury original stone alongside new monument.

From which

- A cedar, 14 ins. diam., bears  $S17^{\circ}E$ , 38.8 ft. dist., mkd. 5 HES 1071 BT.
- A cedar, 5 ins. diam., bears  $S65^{\circ}W$ , 32.7 ft. dist., mkd. X BT.
- A 1/2 inch diam. rebar with yellow cap marked FS CONTROL bears  $S6^{\circ}W$ , 3.77 ft. dist.

Painted red bands around the bearing trees and attached Land Survey Monument and Bearing Tree signs. Set a 6 ft. galvanized steel guard post with Land Survey Marker and Property Boundary decals, West, 2 ft. dist.

Magnetic declination:  $20^{\circ}$  East.

SEE REVERSE SIDE FOR GRANTS BOUNDARY ADJUSTMENT



## CERTIFICATION

Gary Crismon

I, Gary Crismon certify the information shown herein is true and correct.

Gary Crismon  
Signature Ground Party Chief

Ronald A. Pearson

I, Ronald A. Pearson certify that this Corner Record correctly represents work performed by me or under my direction in compliance with the "Corner Recordation Act" (70-22-101, et seq., M.C.A.)

Ronald A. Pearson  
Signature of Surveyor & Seal

Date: 7/10/91 Reg. No. 9008 I.S.

Employer: U.S. FOREST SERVICE

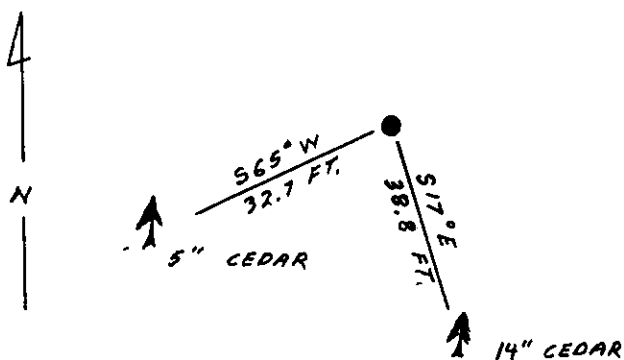

SKETCH OF CORNER (SEE REVERSE SIDE)

Office of Clerk and Recorder, County of Lincoln. This "corner record" was filed for record on Aug 13, 1991 was noted on the cross-index plat and is assigned page No. 4556, in book No. Coral M. Cummings by Bill Buehler

County Official

Cross Index No. 5 HES 1071 T. 35 N. R. 33 W. P.M.M.

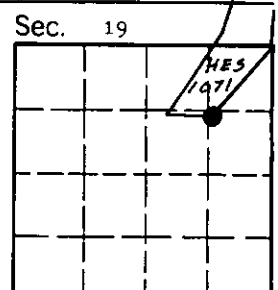

• - corner this sheet

