

## INSTRUCTIONS

1. Original and/or subsequent record used to evaluate the corner position.
2. Description of evidence found, note discrepancies in the record, state method of establishing lost or obliterated corners.
3. Description of monument and accessories set to perpetuate the corner position.
4. Sketch of corner, show all pertinent data which can best be shown in a sketch example, corner marking, topography ties, position of accessories, etc.
5. Certification must be signed and sealed by Land Surveyor registered in the State of Montana.
6. Fill in Cross Index & Section Diagram at bottom of sheet.

## CERTIFIED CORNER RECORDATION

Corner 6 of HES 1071 T. 35 N. R. 33 W. P.M.M. Lincoln County

- I. 1921 H.E.S. original record by Grant Higgins: Placed a small stone, marked with a cross (x) under a sandstone, 24x7x6 ins., 14 ins. in the ground, marked 6 HES 1071 on NE face and a cross (x) on top for the exact corner point, from which.

A cross (x) on a douglas fir tree, 16 ins. dia., bears S56°41'W, 83 lks. (54.78 ft.) dist.

A cross (x) on a douglas fir tree, 14 ins. dia., bears N37°05'W, 99 lks. (65.34 ft.) dist.

Each blazed and scribed 6 HES 1071 BT.

Raise a mound of stone, 4 ft. base, 2 ft. high, NE of corner.

- II. Found a 8x6 ins. stone, firmly set, protruding 8 ins. out of the ground, mkd. 6 HES 1071 on NE face and a cross on top. Mound of stone, 4 ft. dia., 2 ft. high, NE of corner.

From which:

A douglas fir stump, 16 ins. dia., bears S57°W, 55.0 ft. dist., mkd. 6 HES 1071 BT.

A stump hole, bears N37°W, 65.0 ft. dist.

- III. Established two new bearing trees

A larch, 12 ins. dia., bears S10°E, 9.2 ft. dist., mkd. 6 HES 1071 BT.

A larch, 10 ins. dia., bears N50°W, 10.8 ft. dist., mkd. 6 HES 1071 BT.

Painted red bands around the bearing trees and attached Land Survey Monument and Bearing Tree signs.

Set a 6 ft. galvanized steel guard post with Land Survey Marker and Property Boundary decals, East, 3 ft.

Magnetic declination: 20° East.

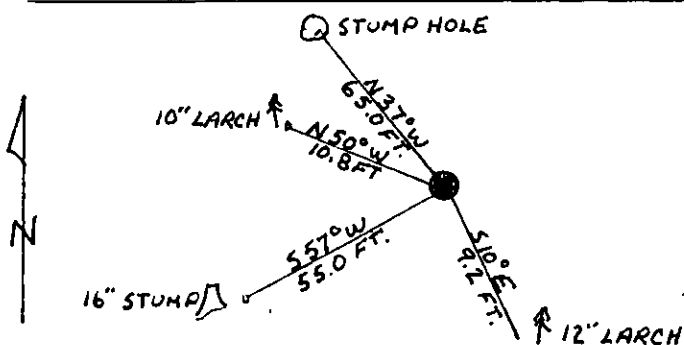

SKETCH OF CORNER

## CERTIFICATION

I, Kevin A. Todd

certify the information shown herein is true and correct.

Kevin A. Todd  
Signature Ground Party Chief

I, Alvah F. Hughes

certify that this Corner Record correctly represents work performed by me or under my direction in compliance with the "Corner Recordation Act" (70-22-101, et seq., M.C.A.)

Alvah F. Hughes  
Signature of Surveyor & Seal

Date: 1/8/91 Reg. No. 7322-LS

Employer: U.S. FOREST SERVICE

Office of Clerk and Recorder, County of Lincoln. This "corner

record" was filed for record on 1-10-91

was noted on the cross-index plat and is assigned page No. 4468, in

book No. \_\_\_\_\_

Coral M. Cummings by Bill Brach  
County Official

6 HES 1071 35 N 33 W

Cross Index No. \_\_\_\_\_ T. \_\_\_\_\_ R. \_\_\_\_\_ PMM

Sec. 19

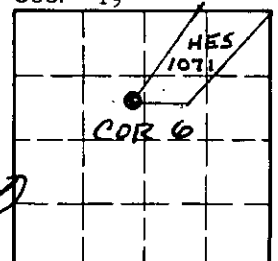

• corner this sheet