

INSTRUCTIONS

1. Original and/or subsequent record used to evaluate the corner position.
2. Description of evidence found, note discrepancies in the record, state method of establishing lost or obliterated corners.
3. Description of monument and accessories set to perpetuate the corner position.
4. Sketch of corner, show all pertinent data which can best be shown in a sketch example, corner marking, topography ties, position of accessories, etc.
5. Certification must be signed and sealed by Land Surveyor registered in the State of Montana.
6. Fill in Cross Index & Section Diagram at bottom of sheet.

CERTIFIED CORNER RECORDATION

Corner 3 of H.E.S. 846 T. 35 N. R. 33 W. P.M.M. Lincoln County

- I. 1917 H.E.S. original record by E. R. Johnson: "Set a small stone, marked with a cross (x) under a granite stone, 26x8x8 ins., 16 ins. in the ground, marked 3 HES 846 on SW face and a cross (x) on top for exact corner point, from which

A cross (x) on a larch tree, 10 ins. dia., bears S11°15'W, 37 lks. dist.

A cross (x) on a fir tree, 12 ins. dia., bears S69°30'W, 45 lks. dist.; each blazed and scribed 3 HES 846 BT.

Raise a mound of earth 4 ft. base, 2 ft. high, SW of corner."

- II. Found a set stone 7x6 ins., 9 ins. out of the ground, marked 3 HES 846 on NW face (red: SW face) and X on top, from which

A saw stump, 24 ins. dia., bears S12°W, 24.8 ft. (37.6 lks.) dist., no visible scribe.

A stump, 26 ins. dia. by 10 ft. high, bears S67°W, 29.4 ft. (44.5 lks.) dist., visible scribe.

- III. Establish two new bearing trees:

A spruce, 30 ins. dia., bears S5°E, 20.2 ft. dist., scribed 3 HES 846 BT.

A spruce, 15 ins. dia., bears S81°E, 25.0 ft. dist., scribed 3 HES 846 BT.

Painted red bands around the bearing trees and attached Land Survey Monument and Bearing Tree signs.

Set a 6 ft. galvanized steel guard post with Land Survey Marker and Property Boundary decals, west, 3 ft.

Magnetic Declination: 20°30' East

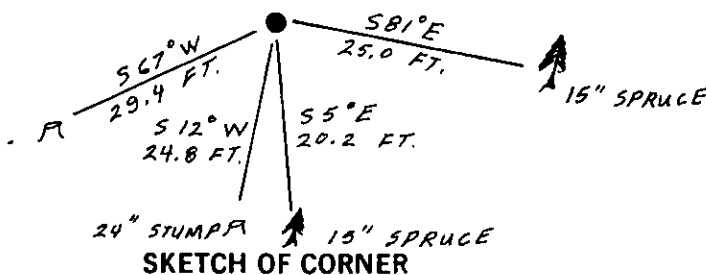
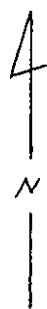

CERTIFICATION

I, Gary C. Crismon
certify the information shown herein is true and correct.

Gary C. Crismon
Signature Ground Party Chief

I, Alvah F. Hughes
certify that this Corner Record correctly represents work performed by me or under my direction in compliance with the "Corner Recordation Act" (70-22-101, et seq., M.C.A.)

Alvah F. Hughes
Signature of Surveyor & Seal

Date: 1/4/90 Reg. No. 7322

Employer: U.S. FOREST SERVICE

Office of Clerk and Recorder, County of Lincoln. This "corner

record" was filed for record on Jan 16, 1990

was noted on the cross-index plat and is assigned page No. 4223, in

book No. _____

Janet B. Sigley
County Official

Cross Index No. 3 HES 846 T. 35 N R. 33 W P.M.M.

Sec. 1

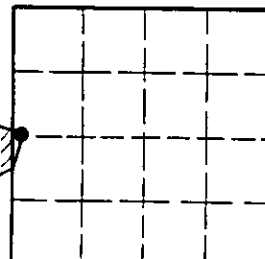

• - corner this sheet