

INSTRUCTIONS

1. Original and/or subsequent record used to evaluate the corner position.
2. Description of evidence found, note discrepancies in the record, state method of establishing lost or obliterated corners.
3. Description of monument and accessories set to perpetuate the corner position.
4. Sketch of corner, show all pertinent data which can best be shown in a sketch example, corner marking, topography ties, position of accessories, etc.
5. Certification must be signed and sealed by Land Surveyor registered in the State of Montana.
6. Fill in Cross Index & Section Diagram at bottom of sheet.

CERTIFIED CORNER RECORDATION

1 of HES 407
1 of HES 405
Corner T. 35 N., R. 33 W., P.M.M. Lincoln County

- I. 1915, original H.E.S. 405 & H.E.S. 407 record by E. Johnson: HES 405 quote: "Identical with Cor. No. 1 of unapproved H.E.S. No. 407, a sandstone 10x10x6 ins. above ground (HES 407 rcd: 24x10x6 ins., 14 ins. in ground) as set by me on July 23, 1915, I mark this stone for Cor. No. 1, H.E.S. 405 on N. face (HES 407 rcd: marked 1 H.E.S. 407 on E. face). From the cross (x) on top

A cross (x) on a larch 8 ins. dia., bears N83°56'E, 115 lks. dist.

A cross (x) on a black pine, 12 ins. dia., bears N29°02'W, 110 lks. dist.; each blazed and scribed 1 H.E.S. 405 BT.

Raise a mound of earth, 4 ft. base, 2 ft. high E. of corner

From this Cor. U.S.L.M. No. 405, in sight a quartzite outcrop 4x10x20 ft. above ground, marked U.S.L.M. 405 on E. face, bears S34°56'W, 3.26 chains dist."

1981, C.O.S. No. 973 by D. Larsen: "Fnd brass cap by B.L.M."

1966, remonumentation by Ira M. Tillotson: No Certified Corner Recordation or other records found.

- II. Found a galvanized steel pipe, 2 ins. dia., 3 ins. above ground, in a collar of stone, 3 ft. dia. with a 2 1/2 in. dia. brass cap, marked as shown

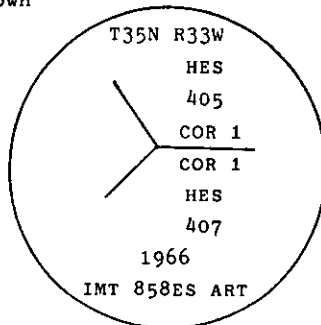

from which

A douglas fir, 28 ins. dia., bears N78°E, 56.6 ft. (85 lks.) dist., healed blaze (origin unknown)

A pine snag, 17 ins. dia., bears N29°W, 72.0 ft. (109 lks.) dist., scribing visible (original record)

- III. Established one new bearing tree:

A lodgepole pine, 8 ins. dia., bears S4°E, 26.9 ft. dist., scribed X and 1 HES 405 BT.

Painted red bands around the bearing trees and attached "Land Survey Monument" and "Bearing Tree" signs where needed.

Set a 6 ft. galvanized steel guard post with "Land Survey Marker" and "Property Boundary" decals, N26°W, 4.3 ft.

Magnetic Declination: 20°30' East

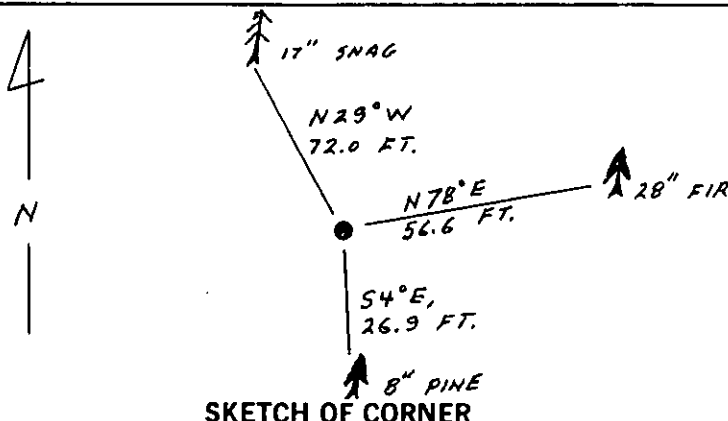

CERTIFICATION

Jane L. Eby

I, Jane L. Eby, certify the information shown herein is true and correct.

Jane L. Eby
Signature Group Party Chief

Alvah F. Hughes

I, Alvah F. Hughes, certify that this Corner Record correctly represents work performed by me or under my direction in compliance with the "Corner Recordation Act" (70-22-101, et seq., M.C.A.)

Alvah F. Hughes
Signature of Surveyor & Seal

Date: 12/7/89 Reg. No. 73225

Employer: U.S. FOREST SERVICE

Office of Clerk and Recorder, County of Lincoln This "corner

record" was filed for record on Dec 19, 1989

was noted on the cross-index plat and is assigned page No. 4164, in

book No. _____

Robert H. Sugil by David Sugil
County Official

1 HES 405 T. 35 N. 33 W. P.M.M.
Cross Index No. _____

Sec. 32

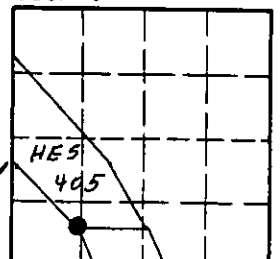

• - corner this sheet