

## INSTRUCTIONS

1. Original and/or subsequent record used to evaluate the corner position.
2. Description of evidence found, note discrepancies in the record, state method of establishing lost or obliterated corners.
3. Description of monument and accessories set to perpetuate the corner position.
4. Sketch of corner, show all pertinent data which can best be shown in a sketch example, corner marking, topography ties, position of accessories, etc.
5. Certification must be signed and sealed by Registered Land Surveyor in State of Montana.
6. Fill in Cross Index & Section Diagram at bottom of sheet.

## CERTIFIED CORNER RECORDATION

Corner No. 4 H.E.S. No. 1059 T. 35N., R. 33 W., P.M.M. Lincoln County  
{Unsurveyed Section 19} Date of Work: September, 1983

## 1. Original Record {June, 1921}

Place a small stone, marked with a cross {x} under a sandstone, 25 x 10 x 10 ins., 15 ins. in the ground, marked 4 HES 1059 on SW. face and a cross {x} on top for the exact corner point, from which:

A cross {x} on a cedar tree, 5 ins. dia., bears S.  $19^{\circ} 25'$  W., 119 lks. dist.

A cross {x} on a spruce tree, 6 ins. dia., bears N.  $28^{\circ} 56'$  W., 52 lks. dist.

Each blazed and scribed: 4 HES 1059 BT.

Raise a mound of stone, 4 ft. base, 2 ft. high, SW. of Corner.

## 2. Evidence found {September, 1983}

Found a 10 X 10 ins. stone, approx. 5 ins. above ground, marked 4 HES 1059 on SW face and a cross {x} on top for the exact corner point, from which:

A cedar tree, 17 ins. dia., bears S.  $19^{\circ} 25'$  W., 119 lks. dist.

A Spruce tree, 34 ins. dia., bears N.  $28^{\circ} 56'$  W., 52 lks. dist.

Each with evidence of chopping where cross {x} has grown over and with evidence of overgrown scribed face blazes towards the base of the trees facing the corner.

## 3. Perpetuation {September, 1983}

Painted Original Stone Monument marking Corner No. 4 HES No. 1059 red, drive 3 foot lath alongside with identifying information, paint overgrown crosses {x} and face blazes red with a red ring painted around the bearing trees at the crosses {x}.

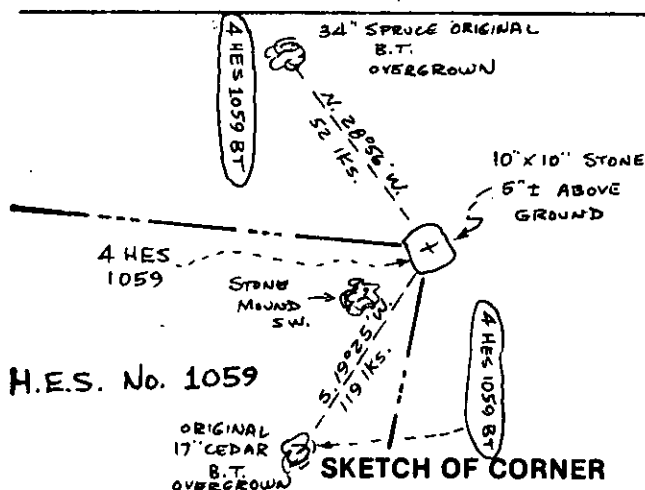

## CERTIFICATION

I, L.A. Dolezal

certify the information shown herein is true and correct.

L.A. Dolezal  
 Signature of Ground Party Chief

I, Melvin D. Lauteren

certify that this Corner Record correctly represents work performed by me or under my direction in compliance with the "Corner Recordation Act" (70-2240, et seq., M.C.A.)

Melvin D. Lauteren  
 Signature of Surveyor & Seal

Date: 9-30-83

Reg. No. 4232S

Employer Kootenai Engineering, Inc.

Office of Clerk and Recorder, County of LINCOLN. This "corner record" ± Sec. 19-T35N-R33W-PM  
 was filed for record on the 3<sup>rd</sup> day of OCT. 19 83, was noted on the cross-index plat and  
 is assigned page No. 2348, in book No. James B. Siegel by Betty L. Concan

County Official deputy

Cross Index No.

T. 35 R. 33 PMM

UNSURVEYED	
Cor. No. 4	H.E.S. No. 1059
(APPROX. ONLY)	
119	

• - corner this sheet