

## INSTRUCTIONS

1. Original and/or subsequent record used to evaluate the corner position.
2. Description of evidence found, note discrepancies in the record, state method of establishing lost or obliterated corners.
3. Description of monument and accessories set to perpetuate the corner position.
4. Sketch of corner, show all pertinent data which can best be shown in a sketch example, corner marking, topography ties, position of accessories, etc.
5. Certification must be signed and sealed by Registered Land Surveyor in State of Montana.
6. Fill in Cross Index & Section Diagram at bottom of sheet.

## CERTIFIED CORNER RECORDATION

Corner No. 3 H.E.S. No. 1059 T. 35 N., R. 33 W., P.M.M. Lincoln County  
 {Unsurveyed Section 19 #} Date of Work: September, 1983

## 1. Original Record {June, 1921}

Place a small stone, marked with a cross {x} under a Sandstone, 24 x 9 x 4 ins., 14 ins. in the ground, marked 3 HES 1059 on SE. face and a cross {x} on top for the exact corner point.

No bearings available, therefore dig pits 24 X 24 X 12 ins. crosswise on line on this and the succeeding course, 7 ft. dist.

Raise a mound of Stone, 4 ft. base, 2 ft. high, SE. of Corner.

## 2. Evidence found {September, 1983}

Found a 9 x 4 ins. stone, approx. 6 ins. above ground, marked 3 HES 1059 on SE. face and a cross {x} on top for the exact corner point.

Found evidence of pits on courses going easterly and southerly from the stone monument approx. 7 ft. dist.

Found a mound of Stone SE. of Corner.

## 3. Perpetuation {September, 1983}

Painted original stone monument marking Corner No. 3 HES No. 1059 red, drive a 3 foot lath alongside with identifying information, from which:

A Larch tree, 8 ins. dia., bears S. 65° W., 2.3 feet dist.

A Larch tree, 7 ins. dia., bears N. 59° E., 18.3 feet dist.

Each marked with a cross {x} above a blaze scribed:  
 3 HES 1059 BT, cross and face of blaze of each painted red with a red ring painted around the trees at cross {x}.

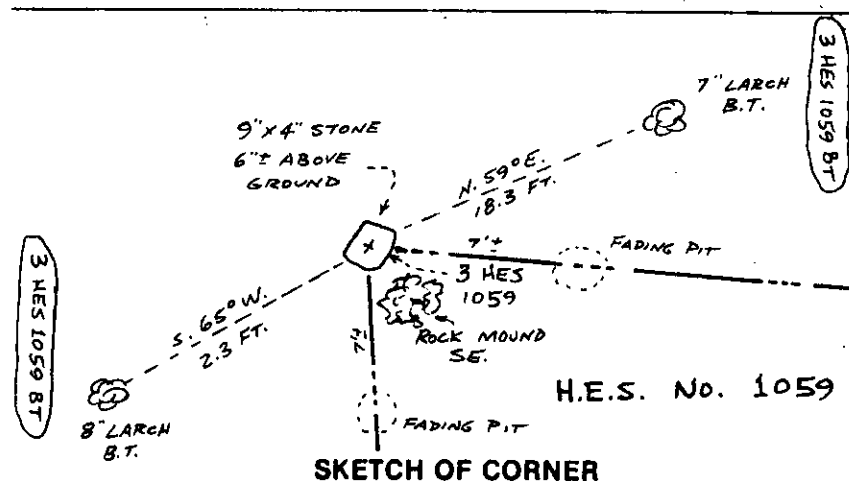

## CERTIFICATION

1. L.A. Dolezal

certify the information shown herein is true and correct.

L.A. Dolezal  
 Signature of Ground Party Chief

1. Melvin D. Lauteren

certify that this Corner Record correctly represents work performed by me or under my direction in compliance with the "Corner Recordation Act" (70-22-101, et seq., M.C.A.)

Melvin D. Lauteren  
 Signature of Surveyor & Seal

Date: 9-30-83 Reg. No. 4232S

Employer: Kootenai Engineering, Inc.

Office of Clerk and Recorder, County of LINCOLN. This "corner record" ± Sec. 19-T35N-R33W-P.M.M.  
 was filed for record on the 31<sup>st</sup> day of OCT. 1983, was noted on the cross-index plat and  
 is assigned page No. 2347, in book No. Chmet BF Siegel by Betty L. Conner

County Official Deputy

Cross Index No.

T. 35

R. 33

P.M.M.

UNSURVEYED	
COR. No. 3	H.E.S. No. 1059
(CROSS INDEX ONLY)	119

• corner this sheet