

CERTIFIED LAND CORNER RECORDATION
(REFERENCE FSM 7153.53)

DESCRIPTION OF CORNER EVIDENCE FOUND, AND ORIGINAL RECORD (IF KNOWN)

Corner falls on top edge of cut along west side of Yaak River Road #92. I found the original cornerstone lying in ditch and plainly marked. (Record- place a small stone, marked with a cross (x) under a sandstone, 43 X 19 X 7 ins. set 23 ins. in slide rock, marked USLM 1071 on SE face and a cross (x) on top for the exact monumental point.) From which: a 19 inch Larch, stump with scribing visible-U.S.L.M. 1071 BT., bears S 51 $\frac{1}{2}$ °W - 135 links. (Record - A cross (x) on a larch tree, 16 ins. Dia., bears S 55° 20'W., 135 links Distance blazed and scribed USLM 1071 BT.) A 13 inch Douglas fir, stump with blaze burned., bears N 40°W-106 links. (Record-A cross (x) on a Douglas Fir tree, 11 in. dia. bears N 39°49'W., 106 links, distance blazed and scribed USLM 1071 BT.)

DESCRIPTION OF MONUMENT AND ACCESSORIES ESTABLISHED
TO PERPETUATE THE ORIGINAL LOCATION OF THIS CORNER:

Date of work: 8/27/69

I set corne r from original re ord bearing and distance.
I set a 2 inch galvanized iron pipe 24 inches in slide rock to bed rock, with brass cap marked
I was unable to move original cornerstone to bury alongside galvanized iron pipe, from which a 4 inch Larch bears S 50°W - 40 links distance, Marked RM.
A 10 inch Douglas fir bears N 85°W-80 links distance, Marked RM

USLM
1071

1969
SUS 2532 S

SKETCH, WITH COURSE AND DISTANCE TO ADJACENT CORNERS IF DETERMINED IN THIS SURVEY.
(MAY SKETCH OR PASTE REPRODUCTION ON REVERSE SIDE.)

(Record from original field notes)

Surveyor's Seal

I, A. R. Trenkle and Glen Pershall
certify that the information shown herein is true and correct.

A. R. Trenkle

Signature of Ground Party Chief

I, Stanley J. Skousen
certify that I have carefully performed or reviewed the work done on the diagrammed corner as reported on this recordation form and approve the same.

Stanley J. Skousen
Signature of Surveyor

DIAGRAM OF CORNER:

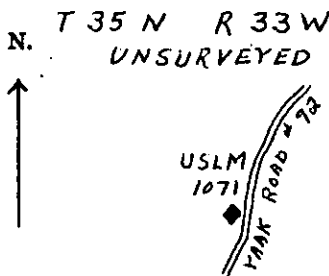

◆ = Corner recorded on the sheet

2532 S
Registration Number

Office of Clerk and Recorder, County of Lincoln

This "corner record" was filed for record on the 19th day of February 19 70, was noted on the cross-index plat and is

assigned page No. 168, in book No. 1

ELEANOR L. VAUGHN, By: Mae Watson
County Official Deputy.

Cross Index No. K-5 T. 35 R. 33 Mer.