

CERTIFIED CORNER RECORDATION

Corner No. 7 HES 408 T. 35 N., R. 32 W., P.M.M. Lincoln County

Record :

1915 HES No. 408 by F.B. Thieme

"Set a small stone marked with a cross (x) under a shale stone 28x13x4 ins., 18 ins. in the ground, marked 7 HES 408 on N. face, and a cross (x) on top for the exact corner point, from which:

A cross (x) on a lodgepole pine tree, 9 ins. dia., bears N. 46°30' E., 31 lks. dist.

A cross (x) on a lodgepole pine tree, 11 ins. dia., bears S. 70°28' E., 33 lks. dist., each blazed and scribed 7 HES 408 BT.

Raise a mound of stone, 4 ft. base, 2 ft. high N. of corner."

Found Evidence :

A shale stone 15 x 3 1/2 ins. 12 ins. exposed above ground marked 7 HES 408 on the N. face with a cross (x) on top, from which:

A 11 inch dia. lodgepole pine stump with visible scribing bears N. 46°E., 20.50 ft. dist.

A lodgepole snag fallen over with visible scribing bears SE of stone monument, no distance was measured, due to being able to determine exact original position.

A mound of stone, 4 ft. base, 2 ft. high, bears N. of monument.

Perpetuation :

I accept the marked stone for Corner No. 7 HES 408.

We established two (2) new bearing trees described as follows:

An alpine fir 5 1/2 ins. dia. bears S. 89° E., 9.40 ft. dist., scribed "7 HES 408 BT".

An alpine fir 4 ins. dia. bears S. 22° W., 8.10 ft. dist., scribed "BT" at the base, with a scribed "x" chest height.

Painted scribed faces red and 6 inch wide red bands around both trees.

Attached Land Survey Monument and Bearing Tree signs to both trees.

Set a steel post 3 ft. NW of corner with attached monument and property line stickers.

Magnetic Declination: 19° East

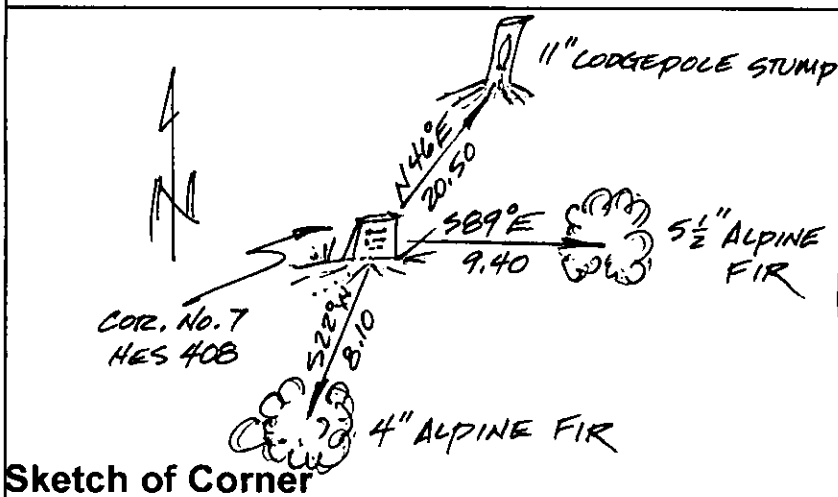

CERTIFICATION

I, John Damon
 certify the information shown herein is true and correct
John Damon
 Signature of Ground Party Chief

I, Shen E. Davis
 certify that this Corner Record correctly represents work performed by
 me or under my direction in compliance with the "Corner Recoraction Act"
 (22-101) P.L. 86-1
Shen E. Davis
 Signature of Surveyor & Seal

Date: 10/13/97 Reg. No. _____
 Employer: _____

Sketch of Corner

Office of Clerk and Recorder, County of Lincoln
 This "corner record" was filed for record on Oct 14, 1997
 was noted on the cross-index plat and is assigned page No. 9981
 in book No. _____
Carol M. Cumming
 County Official

Section

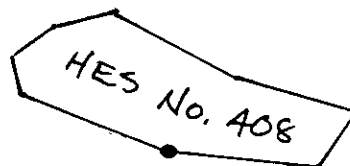

Cross Index No. 7 HES 408 T. 35 N., R. 32 W., PMM

• THIS CORNER