

CERTIFIED CORNER RECORDATION

Corner No. 4 HES 408 T. 35 N., R. 32 W., P.M.M. Lincoln County

Record :

1915 HES 408 by F.B. Thieme

"Identical with Cor. No. 5 of unapproved HES No. 406, a quartzite stone 10x10x5 ins. above ground, as set by me on July 17, 1915. I mark this stone for Cor. No. 4, 4 HES 408 on SW face. From the cross on top:

A cross (x) on a Lodgepole Pine tree, 12 ins. dia., bears S 50°00' W, 15 lks. dist.
A cross (x) on a Lodgepole Pine tree, 12 ins. dia., bears N 23°32' E, 20 lks. dist.,
each blazed and scribed 4 HES 408 BT.

Raise a mound of stone, 4 ft. base, 2 ft. high, SW of corner."

C. of S. No. 1320 by Kootenai Engineering September 1984. No monument set during this survey.

Found Evidence :

During the field search of area, it was noted that heavy logging activities have destroyed the monument and its accessories and no evidence was recovered.

Perpetuation :

We determined the position of Cor. No. 4 using the Grant Boundary Method. At the computed position, set a 2 1/2 inch dia. alum. pipe, 30 ins. long, 26 ins. in the ground with a 3 1/4 inch dia. alum. cap marked as shown below, from which:

A 4 1/2 inch dia. Spruce bears S 86° E, 13.50 ft. dist., scribed "4 HES 408 BT".
A 3 inch dia. Lodgepole Pine bears S 30° W, 8.50 ft. dist., scribed "BT" at its base with a cross (x) at chest height.

Painted scribed faces red and 6 inch wide bands around both Bearing Trees.

Attached Bearing Tree signs to both trees.

Magnetic Declination: 19° East

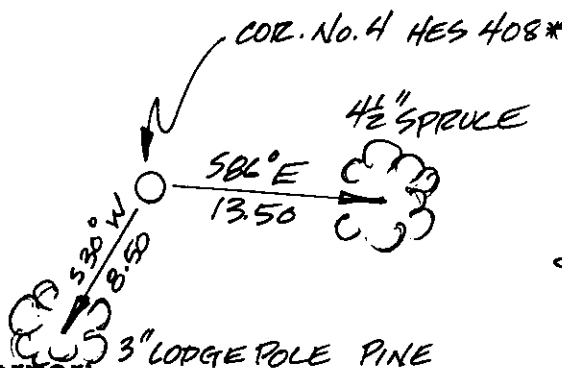
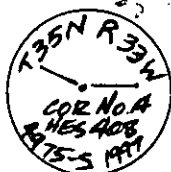

Sketch of Corner

CERTIFICATION

I, John Damon

certify the information shown herein is true and correct

Signature of Ground Party Chief

I, Ken E. Davis

certify that this Corner Record correctly represents work performed by me or under my direction in compliance with the "Corner Recoration Act"

Signature of Surveyor & Seal

Date: 10/13/97

Reg. No. 4975-S

Employer: _____

* SEE BACK OF THIS FORM FOR GRANT BOUNDARY DATA.

Office of Clerk and Recorder, County of Lincoln

This "corner record" was filed for record on Oct 14, 1997
was noted on the cross-index plat and is assigned page No. 9977

in book No. Coral M. Cummings
County Official By DIB

Section

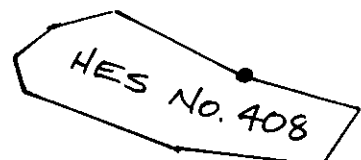

Cross Index No. 4 HES 408 T. 35 N., R. 32 W., PMM

• THIS CORNER

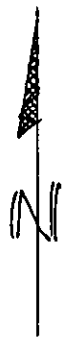

COR. No. 3

(R)
(GB)

S 47°-17'E
S 47°-16'-05"E

H
E
S

REC. S 55°-48-12 E
ME3. S 55°-47-19 E

1960.20
1960.32

3886.48
3886.51

COR. No. 4

No.

(R)
(GB)

S 64°-17'E
S 64°-16'-10"E

1969.44
1969.36

COR. No. 5

408