

INSTRUCTIONS

1. Original and/or subsequent record used to evaluate the corner position.
2. Description of evidence found, note discrepancies in the record, state method of establishing lost or obliterated corners.
3. Description of monument and accessories set to perpetuate the corner position.
4. Sketch of corner, show all pertinent data which can best be shown in a sketch example, corner marking, topography ties, position of accessories, etc.
5. Certification must be signed and sealed by Land Surveyor registered in the State of Montana.
6. Fill in Cross Index & Section Diagram at bottom of sheet.

CERTIFIED CORNER RECORDATION

Corner 2 of HES 1064 T. 35 N. R. 32 W. Lincoln County

- I. 1921 H.E.S. original record by Grant Higgins: Set a granite stone, 24 x 9 x 8 ins., 14 ins. in ground, mkd. 2 HES 1064 on E. face, with a cross on top for exact corner position,

from which:

- A cross (X) on a larch tree, 6 ins. diam., bears N. $30^{\circ} 17'$ E., 87 lks. dist.
 A cross (X) on a larch tree, bears N. $82^{\circ} 23'$ W., 68 lks. dist.
 Each blazed and scribed 2 H E S 1064 BT.
 Raise a mound of earth 4 ft. base, 2 ft. high, E. of corner.

- II. Found a firmly set granite stone, 24x9x6 ins., marked 2 HES 1064 on the E. face. with broken top of rock laying along side. Mound of stone 2 ft. diam. East of corner. Corner position checked by survey.

From which:

- A larch, 21 ins. diam., bears N. 30° E., 57.4 ft. (87 lks.) dist., no visible marks.
 A larch, 19 ins. diam., bears N. 79° W., 44.9 ft. (68 lks.) dist., healed face.

- III. Established one new bearing tree:

- A larch, 21 ins. diam., bears N. 30° E., 57.4 ft. dist., scribed 2 HES 1064 BT.
 Replaced "x" on top of existing monument. Position determined by distance, distance intersection from record bearing trees.

Painted red bands around the bearing trees and attached "Land Survey Monument" and "Bearing Tree" signs where needed.

Set a 6 ft. galvanized steel guard post with "Land Survey Marker" and "Property Boundary" decalcs, N. 12° E. 4 ft. dist.

Magnetic declination: 20° East

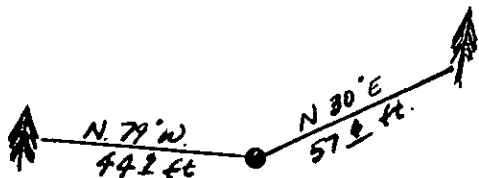

SKETCH OF CORNER

CERTIFICATION

- I, Kenneth Kern
 certify the information shown herein is true and correct.

Kenneth R Kern
 Signature Ground Party Chief

- I, Alvah F. Hughes
 certify that this Corner Record correctly represents work performed by me or under my direction in compliance with the "Corner Recordation Act" (70-22-101, et seq., M.C.A.)

Alvah F. Hughes
 Signature of Surveyor & Seal

Date: 11/26/91 Reg. No. 7322-LS
 Employer: U.S. FOREST SERVICE

Office of Clerk and Recorder, County of Lincoln. This "corner record" was filed for record on 4-21-92 was noted on the cross-index plat and is assigned page No. 5032, in book No. Coral M. Cummings

County Official Coral M. Cummings

2 HES 1064 35 N 32 W

Cross Index No. _____ T. _____ R. _____ PMM

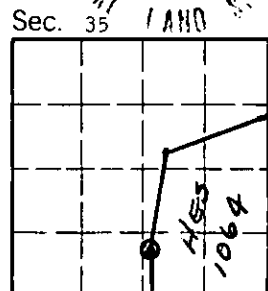

• - corner this sheet