

## INSTRUCTIONS

1. Original and/or subsequent record used to evaluate the corner position.
2. Description of evidence found, note discrepancies in the record, state method of establishing lost or obliterated corners.
3. Description of monument and accessories set to perpetuate the corner position.
4. Sketch of corner, show all pertinent data which can best be shown in a sketch example, corner marking, topography ties, position of accessories, etc.
5. Certification must be signed and sealed by Land Surveyor registered in the State of Montana.
6. Fill in Cross Index & Section Diagram at bottom of sheet.

## CERTIFIED CORNER RECORDATION

Corner 5 of HES 347 T. 35 N. R. 32 W. Lincoln County

- I. 1915 HES 347 record by Fred E. Thieme: "Set for Cor. No. 5, a small stone marked with a cross(x) under a limestone 25x15x5 ins. 15 ins. in the ground, marked 5 HES 347 on SE face, and a cross(x) on top for the exact corner point, from which

A cross(x) on a larch, 26 ins. diam., bears S24°30'E, 54 lks.(35.64 ft.) dist.  
A cross(x) on a larch, 24 ins. diam., bears S80°18'W, 29 lks.(19.14 ft.) dist.  
Each blazed and scribed 5 HES 347 BT.

Raise a mound of earth 4 ft. base, 2 ft. high, SE of corner."

1923 HES 1194 record by J. F. Pfau: "Beginning at Listing Cor. No. 7, identical with Cor. No. 5 of accepted HES 347, which is a limestone 10x10x6 ins. above ground marked and witnessed as described by the Surveyor General. I adopt this cor. as Cor. No. 1 of this survey and mark it 1-HES 1194 on SW face."  
Bearing trees used for HES 347 marked 1 HES 1194 BT.

- II. Found a 4x14 ins. stone, 7 ins. out of the ground, mkd. 5 HES 347 on SE face and 1 HES 1194 on top of stone. From which:

A larch snag, 27 ins. diam., bears S20°E, 35.3 ft. dist., mkd. 5 HES 347 BT, 1 HES 1194 BT.  
A larch stump, 31 ins. diam., bears S80°W, 19.2 ft. dist., visible scribing.

Mound of earth, 2 ft. base, 2 ft. high, 2 ft. east of stone.

- III. Established two new bearing trees:

A lodgepole pine, 6 ins. diam., bears S13°E, 19.3 ft. dist., mkd. 5 HES 347 BT.  
A lodgepole pine, 9 ins. diam., bears S85°W, 27.9 ft. dist., mkd. 5 HES 347 BT.

Painted red bands around the bearing trees and attached "Land Survey Monument" and "Bearing Tree" signs.

Set a galvanized steel guard post with "Land Survey Marker" and "Property Boundary" decals, West, 3 ft.  
Magnetic declination: 20° East

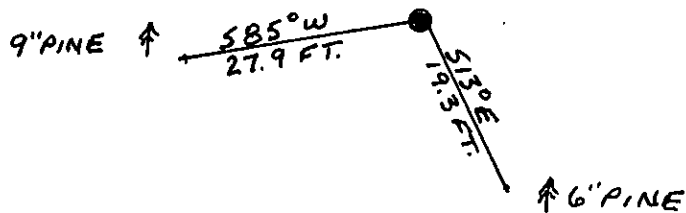
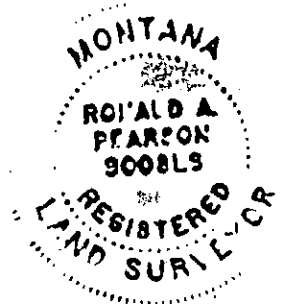

SKETCH OF CORNER

## CERTIFICATION

I, Kevin A. Todd  
certify the information shown herein is true and correct.

Kevin A. Todd  
Signature Ground Party Chief

I, Ronald A. Pearson  
certify that this Corner Record correctly represents work performed by me or under my direction in compliance with the "Corner Recordation Act" (70-22-101 et seq., M.S.A.)

Ronald A. Pearson  
Signature of Surveyor & Seal

Date: 1/2/92 Reg. No. 9008 LS

Employer: U.S. FOREST SERVICE

Office of Clerk and Recorder, County of Lincoln. This "corner record" was filed for record on Jan 16, 1992 was noted on the cross-index plat and is assigned page No. 4619, in book No. \_\_\_\_\_

Carol M. Cunningham  
by Doris D. Cunningham  
5 HES 347 35 N 32 W  
Cross Index No. \_\_\_\_\_ T. \_\_\_\_\_ R. \_\_\_\_\_ PMM

Sec. 24

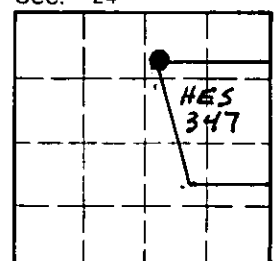

• - corner this sheet