

INSTRUCTIONS

1. Original and/or subsequent record used to evaluate the corner position.
2. Description of evidence found, note discrepancies in the record, state method of establishing lost or obliterated corners.
3. Description of monument and accessories set to perpetuate the corner position.
4. Sketch of corner, show all pertinent data which can best be shown in a sketch example, corner marking, topography ties, position of accessories, etc.
5. Certification must be signed and sealed by Land Surveyor registered in the State of Montana.
6. Fill in Cross Index & Section Diagram at bottom of sheet.

CERTIFIED CORNER RECORDATION

1 of HES 345
4 of HES 342
Corner _____ T. _____ R. _____ P.M.M. _____ Lincoln County

- I. 1915 HES 345 record by Fred E. Thieme: "Set for Cor. No. 1, a small stone marked with a cross(x) under a shale stone 27x15x11 ins. 17 ins. in the ground, marked 1 HES 345 on SE face, and a cross(x) on top for the exact corner point. No bearings available, therefore dig pits 24x24x12 ins. crosswise on line south and on succeeding course 7 ft. dist., and raise a mound of earth 4 ft. base, 2 ft. high, SE of corner.

1915 HES 342 record by Fred E. Thieme: "To Cor. No. 4, identical with Cor. No. 1 of unapproved HES 345 a shale stone 10x15x11 ins. above ground. I mark this stone for Cor. No. 4, 4 HES 342 of NE face."

1923 HES 1194 record by J. F. Pfau: "Identical with Cor. No. 4 of accepted HES 342, and Cor. No. 1 of accepted HES No. 345. I adopt this cor. for Cor. No. 3 of this survey, marking it 3 HES 1194 on W face."

- II. Found a stone, 12x10, 12 ins. out of the ground, mkd. 1 HES 345 on SE face, 4 HES 342 on NE face and 3 HES 1194 on NW face. From which

A lodgepole pine, 11 ins. diam., bears S60° E, 20.0 ft. dist., mkd. 4 HES 342 BT. (No record)

A lodgepole pine, 10 ins. diam., bears S88° W, 13.7 ft. dist., mkd. 4 HES 342 BT. (No record)

Above bearing trees were established by JHN in 1977. (According to found BT signs)

- III. Painted red bands around the bearing trees and attached "Land Survey Monument" and "Bearing Tree" signs.

Set a galvanized steel guard post with "Land Survey Marker" and "Property Boundary" decals, S9° W, 3 ft. Magnetic declination: 20° East

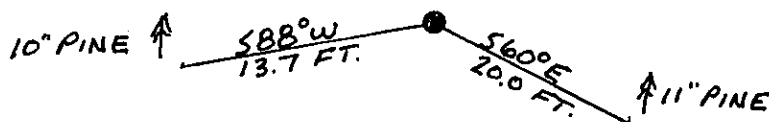
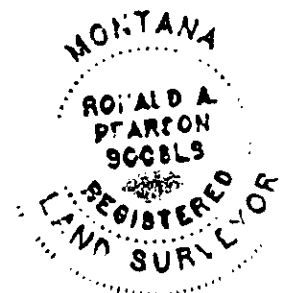

SKETCH OF CORNER

CERTIFICATION
I, Kevin A. Todd
certify the information shown herein is true and correct.
Kevin A. Todd
Signature Ground Party Chief
I, Ronald A. Pearson
certify that this Corner Record correctly represents work performed by me or under my direction in compliance with the "Corner Recordation Act" (70-22-101, et seq., M.C.A.)
Ronald A. Pearson
Signature of Surveyor & Seal
Date: 12/23/91 Reg. No. 9008 LS
Employer: U.S. FOREST SERVICE

Office of Clerk and Recorder, County of Lincoln. This "corner record" was filed for record on Jan 16, 1992 was noted on the cross-index plat and is assigned page No. 4617, in book No. _____

Carol M. Cummings
Official
1 HES 345 35 N 32 W

Cross Index No. _____ T. _____ R. _____ PMM

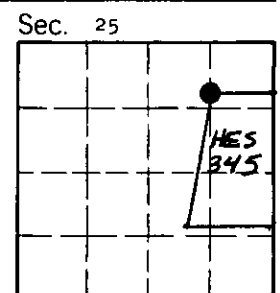

• - corner this sheet