

## INSTRUCTIONS

1. Original and/or subsequent record used to evaluate the corner position.
2. Description of evidence found, note discrepancies in the record, state method of establishing lost or obliterated corners.
3. Description of monument and accessories set to perpetuate the corner position.
4. Sketch of corner, show all pertinent data which can best be shown in a sketch example, corner marking, topography ties, position of accessories, etc.
5. Certification must be signed and sealed by Land Surveyor registered in the State of Montana.
6. Fill in Cross Index & Section Diagram at bottom of sheet.

## CERTIFIED CORNER RECORDATION

Corner 4 of H.E.S. 1135 T. 35 N. R. 32 W. P.M.M. Lincoln County

- I. 1922, H.E.S. original record by J. F. Pfau: "Place a small stone marked with a cross (x) under a slatestone 24x14x6 ins., 14 ins. in the ground, marked 4 HES 1135 on N face, and a cross (x) on top for the exact cor. point, from which

A cross (x) on a spruce tree, 6 ins. dia., bears  $N41^{\circ}15'E$ , 18 lks. dist.

A cross (x) on a lodgepole pine tree, 16 ins. dia., bears  $N63^{\circ}40'W$ , 30 lks. dist., each blazed and scribed 4 H.E.S. 1135 BT.

Raise a mound of stone 4 ft. base, 2 ft. high N of Cor.

- II. Found, a set stone 11x8 ins., 10 ins. out of ground, marked 4 HES 1135 on NW face and X on top, from which

Rotten remains with roots, bears  $N52^{\circ}W$  (red:  $N63^{\circ}40'W$ ), 19.7 ft. (29.8 lks.) dist., portion with BT scribe visible.

A mound of stone 3 ft. base, 1 ft. high, bears  $N15^{\circ}W$ , 3.7 ft. dist.

- III. Established two new bearing trees:

A larch, 15 ins. dia., bears  $N33^{\circ}W$ , 11.2 ft. dist., scribed 4 HES 1135 BT.

A grand fir, 15 ins. dia., bears  $S10^{\circ}W$ , 20.3 ft. dist., scribed 4 HES 1135 BT.

Painted red bands around the bearing trees and attached Land Survey Monument and Bearing Tree signs.

Set a 6 ft. galvanized steel guard post with Land Survey Marker and Property Boundary decals,  $N88^{\circ}W$ , 3 ft.

Magnetic Declination:  $30^{\circ}20'$  East

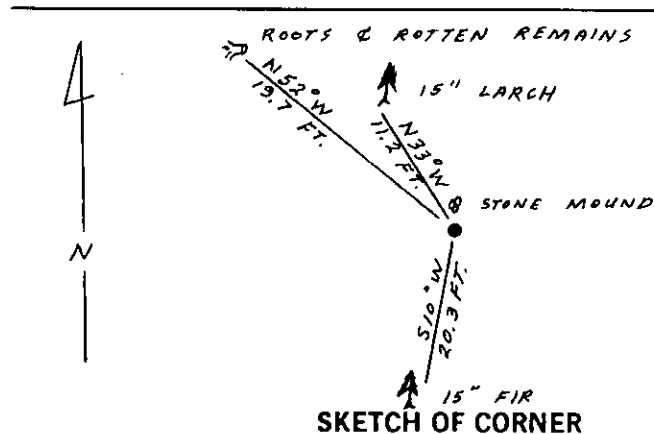
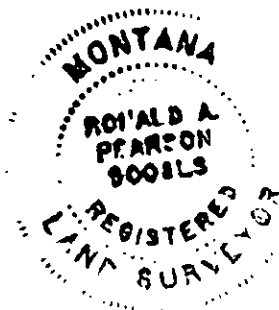

SKETCH OF CORNER

## CERTIFICATION

I, Gary C. Crismon

certify the information shown herein is true and correct.

Gary C. Crismon  
Signature Ground Party Chief

I, Ronald A. Pearson

certify that this Corner Record correctly represents work performed by me or under my direction in compliance with the "Corner Recordation Act" (70-29-101, et seq. M.C.A.)

Ronald A. Pearson  
Signature of Surveyor & Seal

Date: 1/3/90 Reg. No. 9008 LS

Employer: U. S. FOREST SERVICE

Office of Clerk and Recorder, County of Lincoln. This "corner

record" was filed for record on Jan 16, 1990

was noted on the cross-index plat and is assigned page No. 4208, in

book No. \_\_\_\_\_

Janis B. Sigil by Sue Sigil  
County Official

Cross Index No. 4 HES 1135 T. 35 N R. 32 W P.M.M.

Sec. 10

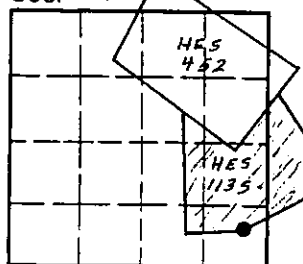

• - corner this sheet