

INSTRUCTIONS

1. Original and/or subsequent record used to evaluate the corner position.
2. Description of evidence found, note discrepancies in the record, state method of establishing lost or obliterated corners.
3. Description of monument and accessories set to perpetuate the corner position.
4. Sketch of corner, show all pertinent data which can best be shown in a sketch example, corner marking, topography ties, position of accessories, etc.
5. Certification must be signed and sealed by Land Surveyor registered in the State of Montana.
6. Fill in Cross Index & Section Diagram at bottom of sheet.

CERTIFIED CORNER RECORDATION

Corner 3 of H.E.S. 1135 T. 35 N. R. 32 W. P.M.M. Lincoln County

- I. 1922. H.E.S. original record by J. F. Pfau: "Place a small stone marked with a cross (x) under a slatestone 30x14x8 ins., 20 ins. in the ground, marked 3 H.E.S. 1135 on NW face, and a cross (x) on top for the exact cor. point, from which

A cross (x) on a tamarack tree, 16 ins. dia., bears S28°30'W, 26 lks. dist.

A cross (x) on a tamarack tree, 24 ins. dia., bears N13°20'W, 40 lks. dist., each blazed and scribed 3 H.E.S. 1135 BT.

Raise a mound of stone 4 ft. base, 2 ft. high NW of Cor.

- II. Found, a set stone, 9x4 ins., 6 ins. out of the ground, marked 3 HES 1135 on the NW face, from which

Rotten stump remains, bears S32°W, 17.3 ft. (26.2 lks.) dist., no visible scribe.

A larch, 23 ins. dia., bears N10°W, 28.0 ft. (42.4 lks.) dist., scribe HES 1135 BT is visible.

A mound of stone, 4 ft. base, 2 ft. high NW of monument.

- III. Established one new bearing tree:

A douglas fir, 11 ins. dia., bears S23°W, 28.4 ft. dist., scribed 3 HES 1135 BT.

Painted red bands around the bearing trees and attached Land Survey Monument and Bearing Tree signs.

Set a 6 ft. galvanized steel guard post with Land Survey Marker and Property Boundary decals, north, 3 ft.

Magnetic Declination: 20°30' East

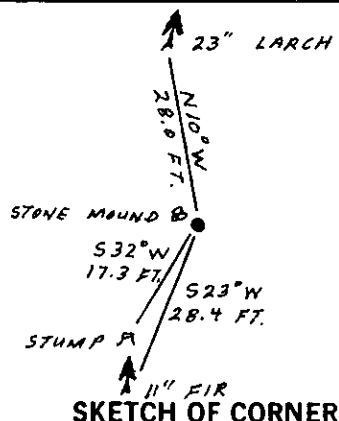
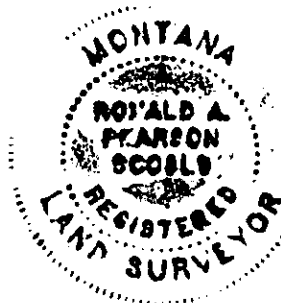

CERTIFICATION

I, Robin Glazier
certify the information shown herein is true and correct.

Signature Ground Party Chief

I, Ronald A. Pearson
certify that this Corner Record correctly represents work performed by me or under my direction in compliance with the "Corner Recordation Act" (70-22-101, et seq., M.C.A.)

Ronald A. Pearson
Signature of Surveyor & Seal

Date: 1/2/90 Reg. No. 9008 LS

Employer: U.S. FOREST SERVICE

Office of Clerk and Recorder, County of Lincoln. This "corner

record" was filed for record on Jan 16, 1990

was noted on the cross-index plat and is assigned page No. 4205, in

book No. _____

Cross Index No. 3 HES 1135 T. 35 N R. 32 W P.M.M.

Adopted July 1, 1981. Montana Board of Professional Engineers & Land Surveyors

