

INSTRUCTIONS

1. Original and/or subsequent record used to evaluate the corner position.
2. Description of evidence found, note discrepancies in the record, state method of establishing lost or obliterated corners.
3. Description of monument and accessories set to perpetuate the corner position.
4. Sketch of corner, show all pertinent data which can best be shown in a sketch example, corner marking, topography ties, position of accessories, etc.
5. Certification must be signed and sealed by Land Surveyor registered in the State of Montana.
6. Fill in Cross Index & Section Diagram at bottom of sheet.

CERTIFIED CORNER RECORDATION

Corner 2 of HES 433 T. 35 N. R. 23 W. P.M.M. Lincoln County

- I. 1915, original HES record by Fred E. Thieme: "Set for Cor. No. 2, a small stone marked with a cross (x) under a sandstone 24x11x7 ins., 14 ins. in the ground, marked 2 H.E.S. 433 on SW. face, and a cross (x) on top for the exact corner point, from which

A cross (x) on a larch tree, 30 ins. dia., bears S34°08'W, 99 lks. dist.

A cross (x) on a larch tree, 32 ins. dia., bears S58°W, 69 lks. dist., each blazed and scribed 2 H.E.S. 433 BT.

Raise a mound of earth and stone, 4 ft. base, 2 ft. high, SW. of corner."

- II. Found loose but set stone, 6x5 ins. 7 ins. out of ground, marked 2-HES 433 on SW face and X on top, from which

A stump, 33 ins. dia., bears S33°W, 65.4 ft. (99 lks.) dist., scribe "2 HES 433 BT" visible.

A stump, 38 ins. dia., bears S60°W, 45.6 ft. (69 lks.) dist., scribe "33 BT" visible.

A mound of earth and stone, 3 ft. base by 1 ft. high, bears SW, 3 ft. dist.

- III. In place of the original stone monument, set a 2 1/2 in. dia., aluminum pipe, 30 ins. long, 25 ins. in the ground with 3 1/4 in. dia. aluminum cap marked as shown:

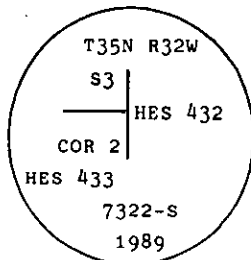

established two new bearing trees:

A larch, 17 ins. dia., bears N76°W, 65.4 ft. dist., scribed "2 HES 433 BT".

A larch, 7 ins. dia., bears N20°W, 52.4 ft. dist., scribed "X BT".

Bury original stone alongside the aluminum monument, unable to find small X stone.
Build a small collar of stone, 18 ins. dia. around monument.

Painted red bands around the bearing trees and attached Land Survey Monument and Bearing Tree signs where needed.

Set a 6 ft. galvanized steel guard post with Land Survey Marker and Property Boundary decals, West, 3 ft.

Magnetic Declination: 20°30' East

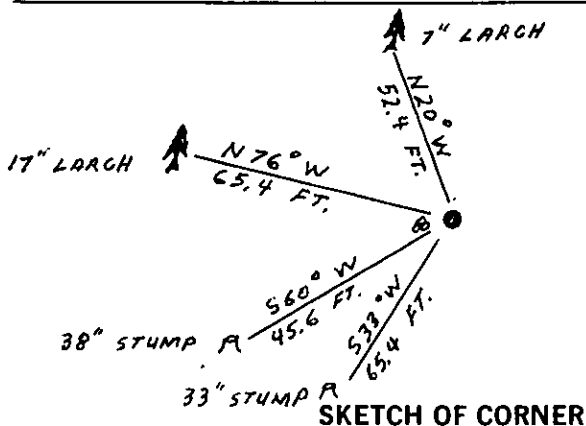

SKETCH OF CORNER

CERTIFICATION

I, Gary C. Crismon
certify the information shown herein is true and correct.

Gary C. Crismon
Signature Ground Party Chief

I, Alvah F. Hughes
certify that this Corner Record correctly represents a corner formed by me or under my direction in compliance with the "Corner Recordation Act" (70-22-101, et seq., M.C.A.).

Alvah F. Hughes
Signature of Surveyor

Date: 12/13/89 Reg. No. 7322-S

Employer: U.S. FOREST SERVICE

Office of Clerk and Recorder, County of Lincoln. This "corner record" was filed for record on Dec 19, 1989

was noted on the cross-index plat and is assigned page No. 4158, in

book No. _____

Cross Index No. 2 HES 433 T. 35 N. R. 32 W. P.M.M.

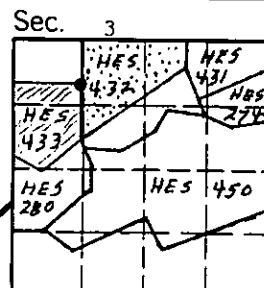

• - corner this sheet