

**CERTIFIED LAND CORNER RECORDATION**

(REFERENCE FSH 5681.65)

## DESCRIPTION OF CORNER EVIDENCE FOUND, AND ORIGINAL RECORD (IF KNOWN)

8 HES 274

No evidence of original corner or bearing trees found.

DESCRIPTION OF MONUMENT AND ACCESSORIES ESTABLISHED  
TO PERPETUATE THE ORIGINAL LOCATION OF THIS CORNER:

Date of work: 7/9/64

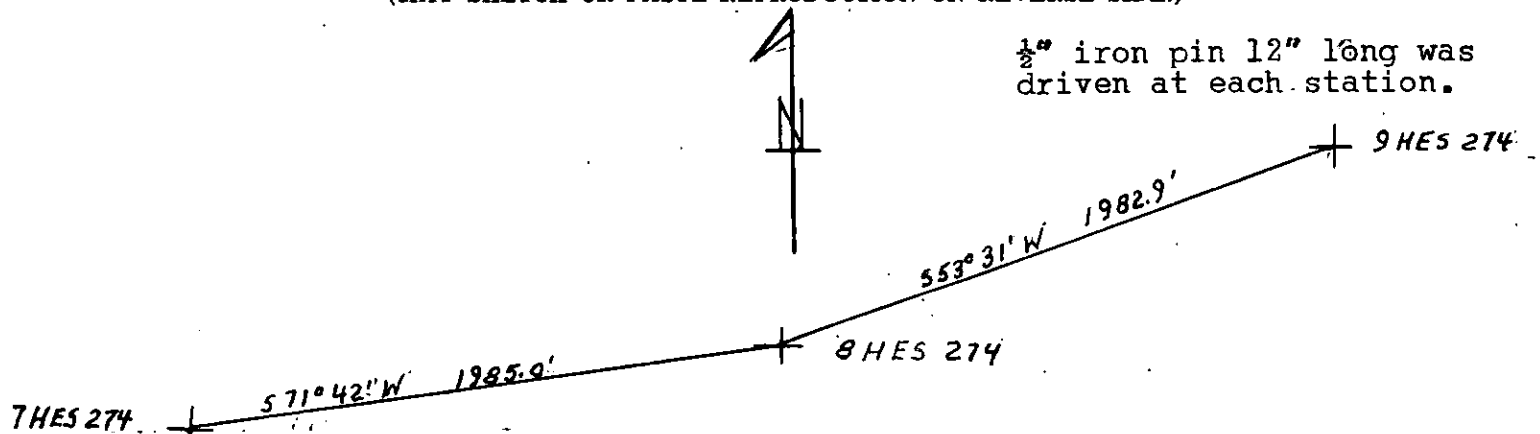
 $\frac{1}{2}$ " reinforced steel pin 12" long set in 10" concrete block 4" below  
surface and approximately on center line of road from which:N W corner of shack bears S  $80^{\circ}$  E 50.1' (Placed) SHACK  
N E corner of shack bears S  $3^{\circ}$  E 24.7' (Placed) SHACKSKETCH, WITH COURSE AND DISTANCE TO ADJACENT CORNERS IF DETERMINED IN THIS SURVEY.  
(MAY SKETCH OR PASTE REPRODUCTION ON REVERSE SIDE.)

Surveyor's Seal

I, George Murphy  
certify that the information shown herein is true and  
correct.George W. Murphy  
Signature of Ground Party ChiefI, E. R. Sievers  
certify that I have carefully performed or reviewed the  
work done on the diagrammed corner as reported on this  
recording form and approve the same.E. R. Sievers  
Signature of Surveyor

## DIAGRAM OF CORNER:

N.

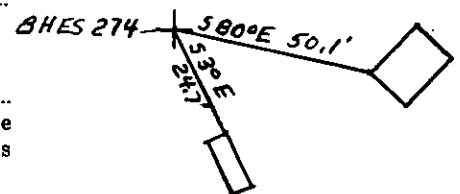

= Corner recorded on the sheet

1946.E.S.  
Registration NumberOffice of Clerk and Recorder, County of LINCOLN, LIBBY, MONTANAThis "corner record" was filed for record on the 22nd day of September, 1964, was noted on the cross-index plat and isassigned page No. 19, in book No. 1M. M. MANSFIELD, By: Mae Watson  
County Official Deputy.Cross Index No. AB-18 T. 35 R. 32 Mer.

Sections 1 &amp; 2