

INSTRUCTIONS

1. Original and/or subsequent record used to evaluate the corner position.
2. Description of evidence found, note discrepancies in the record, state method of establishing lost or obliterated corners.
3. Description of monument and accessories set to perpetuate the corner position.
4. Sketch or corner, show all pertinent data which can best be shown in a sketch example, corner marking, topography ties, position of accessories, etc.
5. Certification must be signed and sealed by Registered Land Surveyor in State of Montana.
6. Fill in Cross Index & Section Diagram at bottom of sheet.

CERTIFIED CORNER RECORDATION

Corner No. 5 HES. 450 T. 35N R. 32W P.M.M. Lincoln County

1. Record: Small stone with cross (X) under a quartzite 24 X 11 X 5 inches, 14 inches in the ground, marked 5 HES 450 on N. face and a cross (X) on top for exact corner point, from which

A cross (X) on a Larch tree, 11 inches diameter bears $N63^{\circ}35'W.$, 35 links distance.

A cross (X) on a Larch tree, 11 inches diameter bears $N51^{\circ}31'E$ 17 links distance; each blazed and scribed 5 HES 450 BT.

Raise a mound of earth 4 feet base, 2 feet high North of corner.

2. Found: original stone 6" X 8" X 16" marked 5 HES 450 on West face, cross (X) on top from which a 24" Larch bears $S62^{\circ}30'E$ 23.5 feet (posted by others)
A 16" Larch bears $S61^{\circ}W$ 6.0 feet (posted by others)
A Larch stump (scribing visible) bears $N55^{\circ}E$ 6.0 feet posted by others.

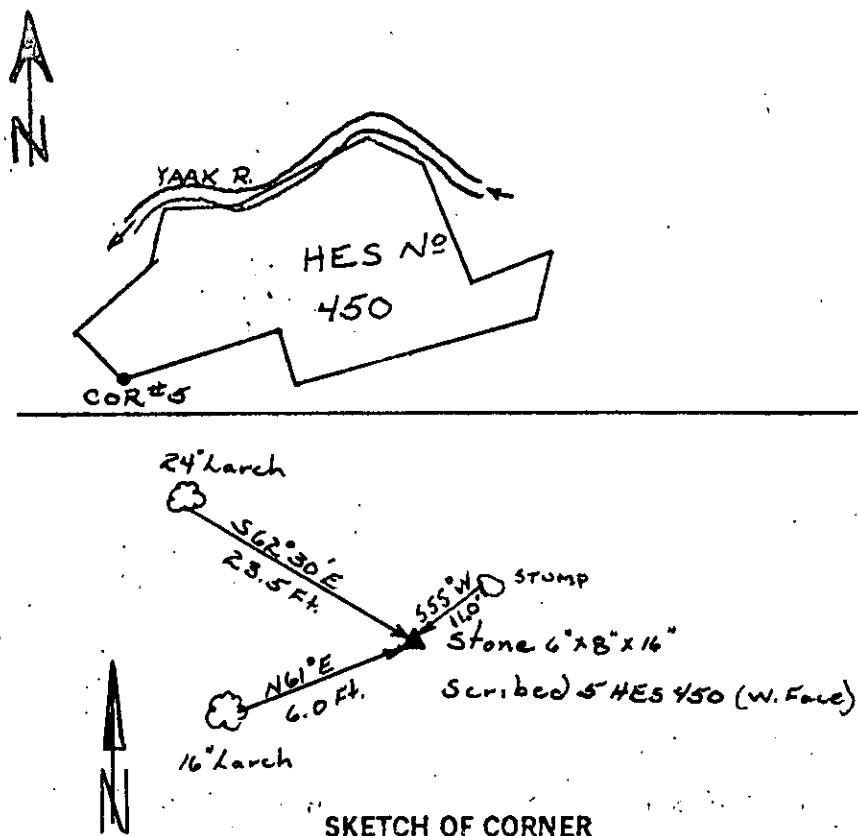

SKETCH OF CORNER

CERTIFICATION

I, David Stanley
certify the information shown herein is true and correct.

David Stanley
Signature Ground Party Chief

I, Jack H. Ninneman
certify that this Corner Record correctly represents work performed by me or under my direction in compliance with the "Corner Recordation Act" (70-22-101, et seq., M.D.A.)

Jack H. Ninneman
Signature of Surveyor & Seal

Date: 5/10/82 Reg. No. 4661S

Employer: Ninneman Engineering Inc.

Office of Clerk and Recorder, County of Lincoln. This "corner record" was filed for record on the May 18th day of 1982 was noted on the cross-index plat and is assigned page No. 1650, in book No. Eleanor L. Hughes by Betty L. Conner

DE-16, 17

County Official T35N., R. 32W., P.M.M.

Sec. Unsurveyed

HES	See
sketch above	

9 - corner this sheet