

## INSTRUCTIONS

1. Original and/or subsequent record used to evaluate the corner position.
2. Description of evidence found, note discrepancies in the record, state method of establishing lost or obliterated corners.
3. Description of monument and accessories set to perpetuate the corner position.
4. Sketch of corner, show all pertinent data which can best be shown in a sketch example, corner marking, topography ties, position of accessories, etc.
5. Certification must be signed and sealed by Registered Land Surveyor in State of Montana.
6. Fill in Cross Index & Section Diagram at bottom of sheet.

## CERTIFIED CORNER RECORDATION

Corner No. 4 HES 450 T. 35N R. 32W P.M.M. Lincoln County

1. Record: a small stone marked with a cross (X) under a shale stone 25 X 12 X 8 inches 15 inches in the ground, marked 4 HES 450 on NE face, and a cross (X) on top for exact corner point, from which a cross (X) on a Larch tree 38 inches diameter bears S41°55'W 114 links distance.

A cross (X) on a Larch tree, 32 inches diameter bears N53°17'W 86 links distance; each blazed and scribed 4 HES 450 BT. Raise a mound of earth 4 feet base 2 feet high NE of corner.

2. Found: original stone 10 X 16 X 20 inches scribed Corner #4 HES 450 Cross (X) on top from which a 36" Larch bears N50°W 56.6 feet posted by others scribing not legible.

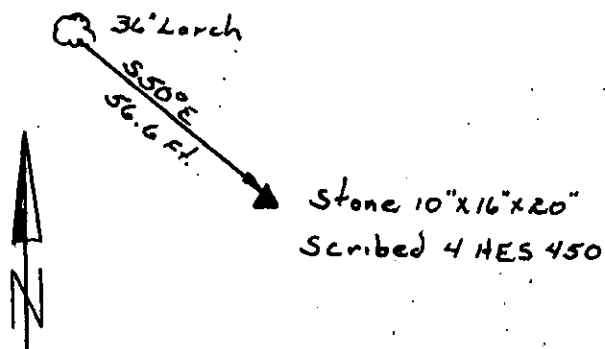
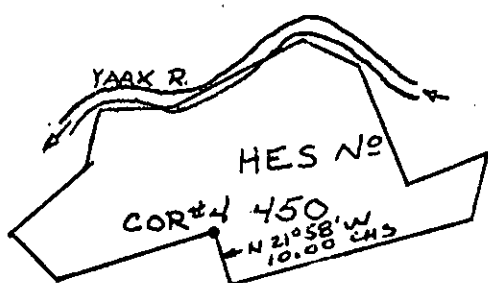

SKETCH OF CORNER

## CERTIFICATION

I, David Stanley

certify the information shown herein is true and correct.

*David Stanley*  
Signature of Record Party Chief

I, Jack H. Ninneman

certify that this Corner Record correctly represents work performed by me or under my direction in compliance with the "Corner Recordation Act" (70-22-101, et seq., M.D.A.)

*Jack H. Ninneman*  
Signature of Surveyor & Seal

Date: 5/10/82 Reg. No. 4661S

Employer: Ninneman Engineering Inc

Office of Clerk and Recorder, County of Lincoln. This "corner record" was filed for record on the May 18<sup>th</sup> day of 1982 was noted on the cross-index plat and is assigned page No. 11649, in book No. Eleanor L. Vaughn by Betty L. Conner

County Official

DE-17519

T. 35N., R. 32W. P.M.M.

Cross Index No.

T.

R.

P.M.M.

• corner this sheet

## Sec. Unsurveyed

HES			
See sketch			
above			