

## INSTRUCTIONS

1. Original and/or subsequent record used to evaluate the corner position.
2. Description of evidence found, note discrepancies in the record, state method of establishing lost or obliterated corners.
3. Description of monument and accessories set to perpetuate the corner position.
4. Sketch or corner, show all pertinent data which can best be shown in a sketch example, corner marking, topography ties, position of accessories, etc.
5. Certification must be signed and sealed by Registered Land Surveyor in State of Montana.
6. Fill in Cross Index & Section Diagram at bottom of sheet.

## CERTIFIED CORNER RECORDATION

Corner No. 12 H.E.S. 495 T. 35N R. 32W P.M.M. Lincoln County

1. Original monument description not available.
2. Found: old fence row and intersection of old fence line. New fence alongside said by owner of H.E.S. 495 to be four feet more or less south and west of corner location.
3. Set 5/8" X 24" capped steel pin stamped J.H.N. 4661S at computed location (Distance-Distance intersection.) Location verified by old fence row. No trees in the area.

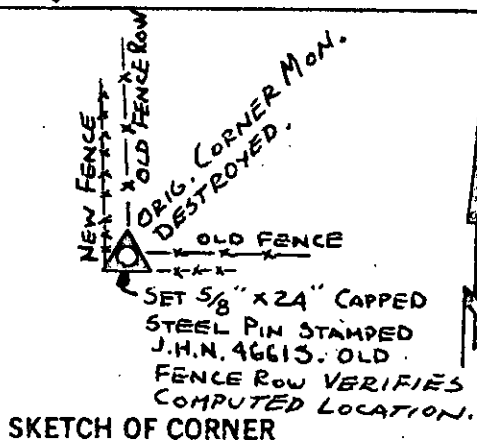
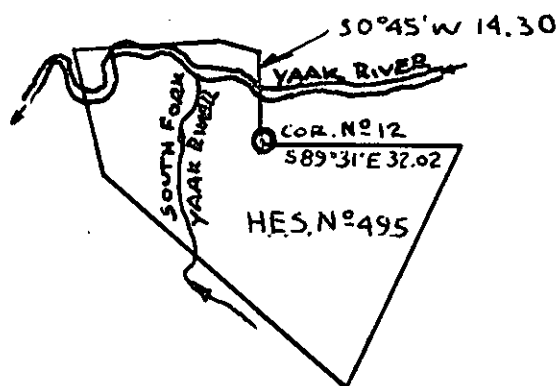

SKETCH OF CORNER

## CERTIFICATION

I, \_\_\_\_\_, certify the information shown herein is true and correct.

Signature Ground Party Chief

I, Jack H. Ninneman

certify that this Corner Record correctly represents work performed by me or under my direction in compliance with the "Corner Recordation Act" (70-22-101, et seq., M.D.A.)

Signature of Surveyor & Seal

Date: 3/9/82 Reg. No. 4661S

Employer: Ninneman Engineering Inc.

Office of Clerk and Recorder, County of Lincoln. This "corner record" was filed for record on the March 11<sup>th</sup> day of 1982, was noted on the cross-index plat and is assigned page No. 1599, in book No. 1.

Eleanor L. Vaughn by Betty L. Conner  
County Official Deputy

35N 32W

Cross Index No. \_\_\_\_\_

T. \_\_\_\_\_

R. \_\_\_\_\_

P.M.M. \_\_\_\_\_

Sec. 1

HES	495
UNSURVEYED	SECTION

• corner this sheet