

## INSTRUCTIONS

1. Original and/or subsequent record used to evaluate the corner position.
2. Description of evidence found, note discrepancies in the record, state method of establishing lost or obliterated corners.
3. Description of monument and accessories set to perpetuate the corner position.
4. Sketch or corner, show all pertinent data which can best be shown in a sketch example, corner marking, topography ties, position of accessories, etc.
5. Certification must be signed and sealed by Registered Land Surveyor in State of Montana.
6. Fill in Cross Index & Section Diagram at bottom of sheet.

## CERTIFIED CORNER RECORDATION

Corner No. 6 H.E.S. No. 495 35N 32W Lincoln County  
T. \_\_\_\_\_ R. \_\_\_\_\_ P.M.M. \_\_\_\_\_

1. Original monument description not available.

2. Found: Stone 6" X 10" X 20" scribed 10 H.E.S. 274 on West face and 5 H.E.S. 431 on East face a 36" Fir (which bears S 70° E 42.6 feet) scribed 6 H.E.S. 495 and posted. A stone mound 4 feet west of stone monument.

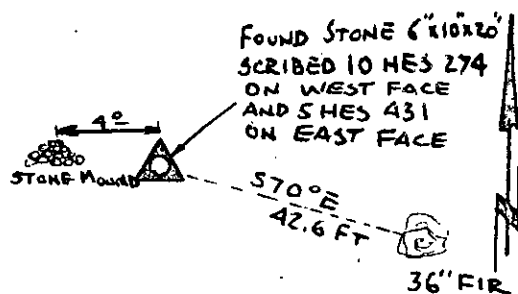
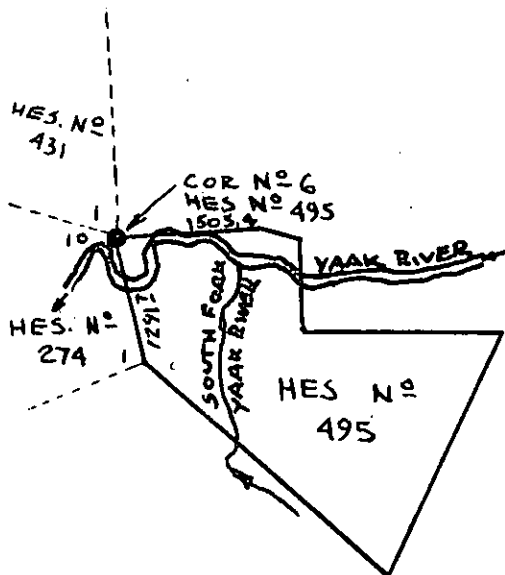

SKETCH OF CORNER

## CERTIFICATION

I, David B. Stanley

certify the information shown herein is true and correct.

David B. Stanley  
Signature Ground Party Chief

I, Jack H. Ninneman

certify that this Corner Record correctly represents work performed by me or under my direction in compliance with the "Corner Recordation Act" (70-22-101, et seq., M.D.A.)

Jack H. Ninneman  
Signature of Surveyor & Seal

Date: 3/9/82 Reg. No. 4661S

Employer: Ninneman Engineering Inc.

Office of Clerk and Recorder, County of Lincoln. This "corner record" was filed for record on the March 11<sup>th</sup> day of 1982 was noted on the cross-index plat and is assigned page No. 1598, in book No. 1

Eleanor L. Vaughn by Betty L. Coners  
County Official Deputy

Sec. 1

HES 495
UNSURVEYED
SECTION

Cross Index No. \_\_\_\_\_ T. 35N R. 32W P.M.M.

• corner this sheet