

CERTIFIED LAND CORNER RECORDATION

Corner in south bdy Resurvey for S $\frac{1}{4}$ cor. Sec. 36 only Twp. 35 N., R. 29 W., M.P.M.

DESCRIPTION OF CORNER EVIDENCE FOUND, AND ORIGINAL RECORD (IF KNOWN)

Original
1930 T 35N R 29W GLO notes Vol. 8152 Page 5 Lincoln County, Mont.
Corner Desc. 1" Iron post, 3' long set 20" into ground in mound of stone
Has USGLO Std. Brass cap mkd $\frac{1}{4}$ S36
1930
10" Fir bears N 33°W 30 lks. 10" Yellow Pine bears N60°E 23 lks.
mkd $\frac{1}{4}$ S 36 BT mkd $\frac{1}{4}$ S 36 BT
Found pipe with brass cap mkd $\frac{1}{4}$ S36 The 10" yellow pine BT reported is
1930 live growing-still only 10" dia.-
Scribing legible. The 10" Fir reported is live, growing-now 12"
Scribing legible. The pipe was bent over probably from rolling rocks-No mound
of stone, pipe only about 18" long

DESCRIPTION OF MONUMENT AND ACCESSORIES ESTABLISHED TO PERPETUATE THE ORIGINAL LOCATION OF THIS CORNER:

Date of work: 18/8/1966

We tagged 12" Fir with FS BT sign, we tagged 10" Yellow pine with FS BT sign.
We reset STD Brass Cap in a mound of stone on Bedrock

SKETCH, WITH COURSE AND DISTANCE TO ADJACENT CORNERS IF DETERMINED IN THIS SURVEY.
(MAY SKETCH OR PASTE REPRODUCTION ON REVERSE SIDE.)

~ See other side ~

Surveyor's Seal

DIAGRAM OF CORNER:

I, Jack Ninneman
certify that the information shown herein is true and correct

N.

Jack Ninneman
Signature of Ground Party Chief

Jack Ninneman

I, Jack Ninneman
certify that I have carefully performed or reviewed the
work done on the diagrammed corner as reported on this
recording form and approve the same.

Jack Ninneman
Signature of Surveyor

T35 N $\frac{1}{4}$ 36 R. 29W
T34 N R 29W

◄◄ = Corner recorded on the sheet

Mont. 534 ES
Registration Number

Office of Clerk and Recorder, County of Lincoln

This "corner record" was filed for record on the 5th day of January 1967, was noted on the cross-index plat and is

assigned page No. 58, in book No. 1

ELEANOR L. VAUGHN, By: *Eleanor L. Vaughn*
County Official Deputy.

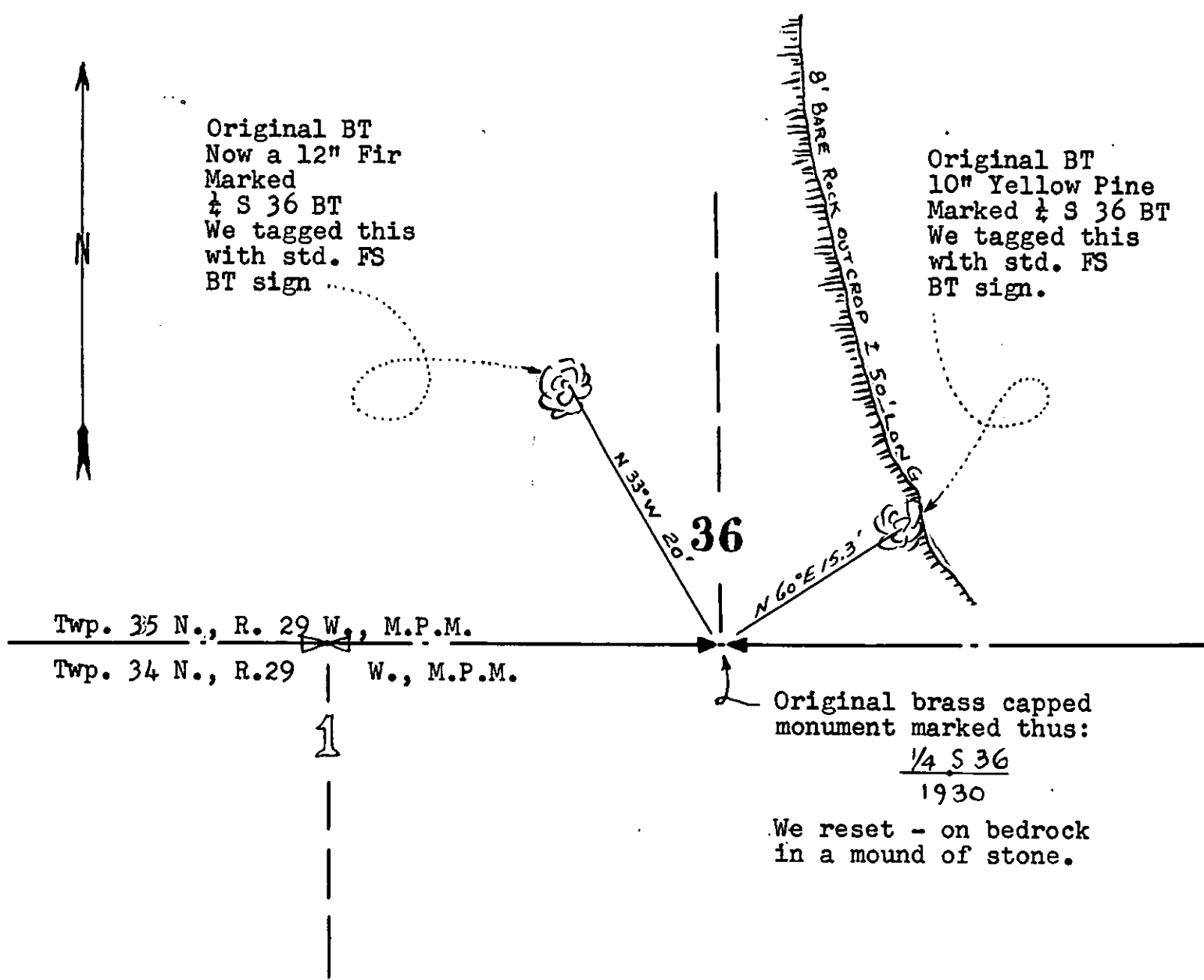

NOTE: We found the original brass capped monument marked as reported, however the pipe was only about 18" long and bent over (probably from rolling rocks) There was no mound of stone. Because of this we reset the monument as reported above.

STATE OF MONTANA
COUNTY OF LINCOLN

Filed this 5th day of January A.D. 1969

at 2:10 P.M.

By *W. A. S. & Co.* County Clerk

By *W. A. S. & Co.* Deputy