

CERTIFIED CORNER RECORDATION

Corner SW Sec. Corner Sec. 17 T. 35N R. 27W P.M, MT Lincoln County

I. 1913 G.L.O. original record by Lewellyn D. Lyman and Royston C. Durnford: Set a stone and four bearing trees.

1970 B.L.M. remonumentation record by Joseph E French: The corner of secs. 17, 18, 19, and 20, monumented with a limestone, 12x12x7 ins., firmly set, mkd. with 3 notches on S. and 5 notches on the E. edges, and witnessed by the remains of the original bearing trees.

- A fir stump, 16 ins. diam., bears N11 1/2°E, 82 lks. dist., mkd "T35N R27W S17 BT".
- A fir stump, 15 ins. diam., bears S68 1/2°E, 59 lks. dist., mkd "T35N R27W S20 BT".
- A fir stump, 13 ins. diam., bears S46°W, 42 lks. dist., with no visible scribing.
- A fir stump, 17 ins. diam., bears N51 3/4°W, 74 lks. dist., mkd "T35N R27W S18 BT".

At the corner point, set an iron post, 30 ins. long, 2 1/2 ins. diam., 24 ins. in the ground, with brass cap marked:

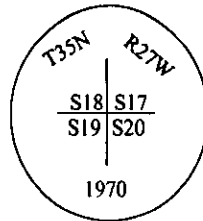

Established 4 new bearing trees:

- A fir, 8 ins. diam., bears N74°E, 105 lks. dist., mkd "T35N R27W S17 BT".
- A fir, 8 ins. diam., bears S57 1/4°E, 78 lks. dist., mkd "T35N R27W S20 BT".
- A pine, 15 ins. diam., bears S74°W, 13 lks. dist., mkd. "T35N R27W S19 BT".
- A fir, 8 ins. diam., bears N45°W, 40 lks. dist., mkd "T35N R27W S18 BT".

bury the original stone alongside the iron post.

- II. Found a B.L.M. brass cap, 5 in. out of ground, firmly set, mkd. as shown above: from which:
- A fir stump, 16 ins. diam., bears N11°E, 54.7 FT. (82 lks.) dist., with visible scribing. (G.L.O.)
 - A fir, 11 ins. diam., bears N74°E, 69.3 ft.(105 lks.) dist., with visible scribing. (B.L.M.)
 - A fir stump, 16 ins. diam., bears S68°E, 38.9 ft. (59 lks.) dist. with visible scribing. (G.L.O.)
 - A fir, 11 ins. diam., bears S57°E, 51.5 ft. (78 lks.) dist., healed face. (B.L.M.)
 - A fir stump, 14 ins. diam., bears S46°W, 27.7 (42 lks.) dist., with no visible scribing. (G.L.O.)
 - A pine, 19 ins. diam., bears S70°W, 8.6 ft. (13 lks.) dist., healed face. (B.L.M. record S74°W)
 - A root crown, bears N51°W, 48.9 ft. (74 lks.) dist.,. (G.L.O.)
 - A fir stump, 14 ins. diam., bears N45°W, 26.4 ft. (40 lks.) dist., with no visible scribing. (B.L.M.)

- III. Established one new bearing tree:
- A fir, 8 ins. diam., bears N68°W, 59.2 ft. dist., mkd. "T35N R27W S18 BT".

Painted red bands around the bearing trees and attached Land Survey Monument and Bearing Tree signs.

Magnetic Declination: 20° East

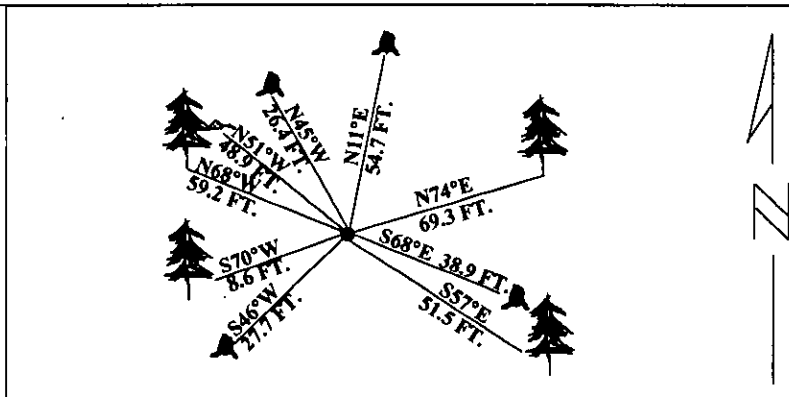

SKETCH OF CORNER

CERTIFICATION

I. **Mark Federman**

certify the information shown herein is true and correct.

Mark Federman
Signature Ground Party Chief

I. **Alvah F. Hughes**

certify that this Corner Record correctly represents work performed by me or under my direction in compliance with the "Corner Recordation Act" (70-224101, as amended, M.C.A.)

Alvah F. Hughes
Signature of Surveyor & Seal

Date: **12/15/95**

Reg. No.: **7322LS**

Employer: **U.S. FOREST SERVICE**

Office of Clerk and Recorder, County of **LINCOLN**. This "corner record" was filed for record on **JULY 29, 1997** was noted on the cross-index plat and is assigned page No. **9789** in book No. **CORAL M. CUMMINGS** By *OUR*

County Official

Sec. 17

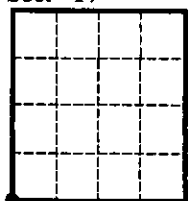

• - corner this sheet

Cross Index No.

N-5

T.

35N

R.

27W

PMM