

CERTIFIED LAND CORNER RECORDATION  
(REFERENCE FSM 7153-53)

DESCRIPTION OF CORNER EVIDENCE FOUND, AND ORIGINAL RECORD (IF KNOWN)

At the C-W 1/16 corner of Section 29; T35N, R27W, Lincoln County, Montana:

NO ORIGINAL EVIDENCE

DESCRIPTION OF MONUMENT AND ACCESSORIES ESTABLISHED  
TO PERPETUATE THE ORIGINAL LOCATION OF THIS CORNER:

Date of work: April, 1980

At the corner a 3- $\frac{1}{2}$ " alum. cap was set on a 2"x30" pipe,  
24" in the ground with a small mound of stone. The following  
RM's were set:

A 16" larch bears N.22°W., 42.5 feet  
An 8" larch bears N.68 $\frac{1}{2}$ °W., 40.5 feet

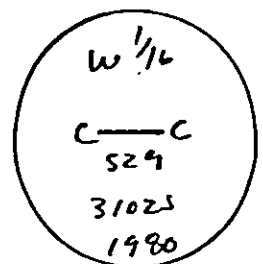

Variance: 19-3/4°

SKETCH, WITH COURSE AND DISTANCE TO ADJACENT CORNERS IF DETERMINED IN THIS SURVEY.  
(MAY SKETCH OR PASTE REPRODUCTION ON REVERSE SIDE.)

See Certificate of Survey Number \_\_\_\_\_

Surveyor's Seal

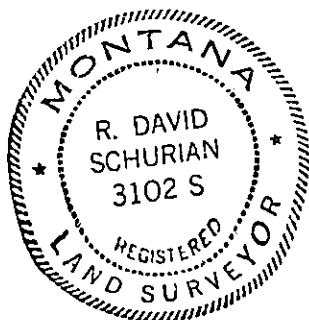

I, Paul S. Long, Jr.  
certify that the information shown herein is true and  
correct.

Paul S. Long, Jr.  
Signature of Ground Party Chief

I, R. David Schurian  
certify that I have carefully performed or reviewed the  
work done on the diagrammed corner as reported on this  
recording form and approve the same.

R. David Schurian  
Signature of Surveyor

31025  
Registration Number

DIAGRAM OF CORNER:  
T35N. R27W  
SECTION 29

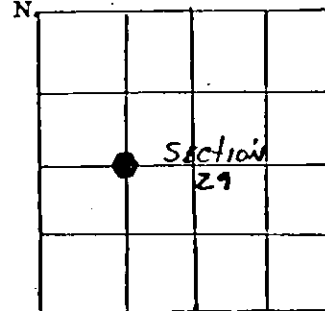

= Corner recorded on the sheet

Office of Clerk and Recorder, County of Lincoln

This "corner record" was filed for record on the 30th day of June, 1980, was noted on the cross-index plat and

assigned page No. 808, in book No. \_\_\_\_\_

Sharon L. Vaughan  
County Office Sharon M. Weiskopf

Cross Index No. T-7 T 35N R 27W