

CERTIFIED LAND CORNER RECORDATION  
(REFERENCE FSM 7153.53)

DESCRIPTION OF CORNER EVIDENCE FOUND, AND ORIGINAL RECORD (IF KNOWN)

At the C-E 1/16 corner of Section 30, T35N, R27W, Lincoln County, Montana:

NO ORIGINAL EVIDENCE

DESCRIPTION OF MONUMENT AND ACCESSORIES ESTABLISHED  
TO PERPETUATE THE ORIGINAL LOCATION OF THIS CORNER:

Date of work: April, 1980

Set a 3-1/4" alum. cap on a 2"x30" pipe 22" in the ground  
with a small mound of stone. The following RM's were set:

A 6" lodgepole pine bears N.88°E., 19.3 feet  
A 7" fir bears S.14-1/2°E., 2.1 feet

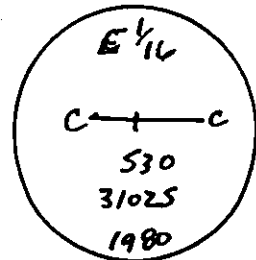

Variance: 19-3/4°

SKETCH, WITH COURSE AND DISTANCE TO ADJACENT CORNERS IF DETERMINED IN THIS SURVEY.  
(MAY SKETCH OR PASTE REPRODUCTION ON REVERSE SIDE.)

See Certificate of Survey Number \_\_\_\_\_

Surveyor's Seal

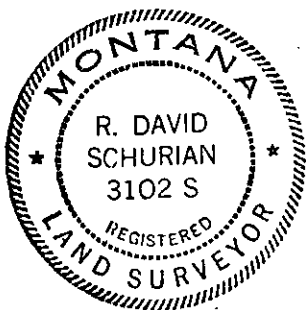

I, Paul S. Long, Jr.  
certify that the information shown herein is true and correct.

*Paul S. Long, Jr.*

Signature of Ground Party Chief

I, R. David Schurian  
certify that I have carefully performed or reviewed the  
work done on the diagrammed corner as reported on this  
recording form and approve the same.

*R. David Schurian*

Signature of Surveyor

DIAGRAM OF CORNER:

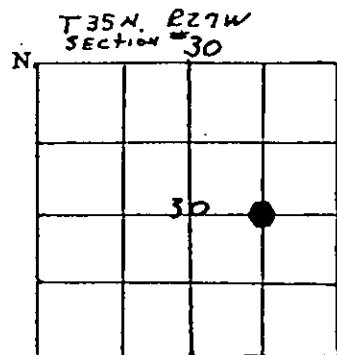

= Corner recorded on the sheet

3102S  
Registration Number

Office of Clerk and Recorder, County of Lincoln

This "corner record" was filed for record on the 24<sup>th</sup> day of June 1980, was noted on the cross-index plat and assigned page No. 806, in book No. \_\_\_\_\_

*Eleanor P. Vaughn*  
County Official

Cross Index No. T-4 T 35N R 27W Me