

CERTIFIED LAND CORNER RECORDATION  
(REFERENCE FSM 7153.53)

DESCRIPTION OF CORNER EVIDENCE FOUND, AND ORIGINAL RECORD (IF KNOWN)

At the corner of, C-S-NE 1/64 corner of Section 30, T35N, R27W, Lincoln County, Montana:

NO ORIGINAL EVIDENCE

DESCRIPTION OF MONUMENT AND ACCESSORIES ESTABLISHED  
TO PERPETUATE THE ORIGINAL LOCATION OF THIS CORNER:

Date of work: April, 1980

Set a 3- $\frac{1}{4}$ " alum. cap on a 2"x30" pipe 24" in the ground.  
A fiberglass post .8' to the North. Small mound of  
stone. The following RM's were set:

An 11" fir bears S.34 $\frac{1}{2}$ °E., 49.5 feet  
A 7" fir bears S.74 $\frac{1}{2}$ °W., 6.6 feet

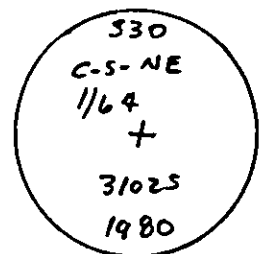

Variance: 19-3/4°

SKETCH, WITH COURSE AND DISTANCE TO ADJACENT CORNERS IF DETERMINED IN THIS SURVEY.  
(MAY SKETCH OR PASTE REPRODUCTION ON REVERSE SIDE.)

See Certificate of Survey Number \_\_\_\_\_

Surveyor's Seal



I, Paul S. Long, Jr.  
certify that the information shown herein is true and  
correct.

*Paul S. Long, Jr.*

Signature of Ground Party Chief

I, R. David Schurian  
certify that I have carefully performed or reviewed the  
work done on the diagrammed corner as reported on this  
recording form and approve the same.

*R. David Schurian*

Signature of Surveyor

DIAGRAM OF CORNER:

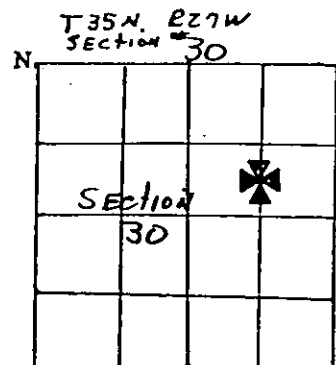

3102S

Registration Number

Office of Clerk and Recorder, County of Lincoln

This "corner record" was filed for record on the 24<sup>th</sup> day of June, 1980, was noted on the cross-index plat and is  
assigned page No. 805, in book No. \_\_\_\_\_

*Elaine L. Vaughn*  
County Official

Cross Index No. 0-P-4 T. 35N R. 27W Mer.