

CERTIFIED LAND CORNER RECORDATION  
(REFERENCE FSM 7153.53)

DESCRIPTION OF CORNER EVIDENCE FOUND, AND ORIGINAL RECORD (IF KNOWN)

At the C-S 1/16 corner of Section 19, T35N, R27W, Lincoln County, Montana:

NO ORIGINAL EVIDENCE

DESCRIPTION OF MONUMENT AND ACCESSORIES ESTABLISHED  
TO PERPETUATE THE ORIGINAL LOCATION OF THIS CORNER:

Date of work: April, 1980

At the corner a 3- $\frac{1}{4}$ " alum. cap on a 2"x30" pipe was set  
22" in the ground with a small mound of stone. The following  
RM's were set:

- A 10" larch bears N.49°E., 10.8 feet
- A 12" larch bears S.26°W., 4.0 feet

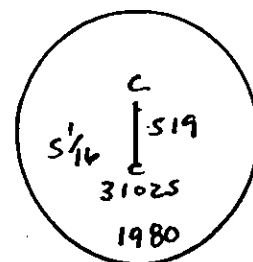

Variance: 19-3/4°

SKETCH, WITH COURSE AND DISTANCE TO ADJACENT CORNERS IF DETERMINED IN THIS SURVEY.  
(MAY SKETCH OR PASTE REPRODUCTION ON REVERSE SIDE.)

See Certificate of Survey Number \_\_\_\_\_

Surveyor's Seal

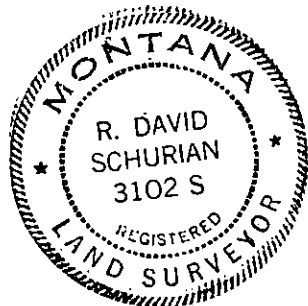

I, Paul S. Long, Jr.  
certify that the information shown herein is true and  
correct.

Paul S. Long, Jr.  
Signature of Ground Party Chief

I, R. David Schurian  
certify that I have carefully performed or reviewed the  
work done on the diagrammed corner as reported on this  
recording form and approve the same.

R. David Schurian  
Signature of Surveyor

3102S

Registration Number

DIAGRAM OF CORNER:

T35N. R27W  
SECTION #19

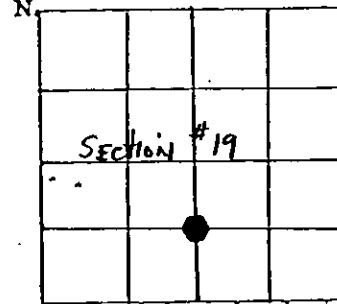

= Corner recorded on the sheet

Office of Clerk and Recorder, County of Lincoln

This "corner record" was filed for record on the 24<sup>th</sup> day of June, 1980, was noted on the cross-index plat and  
assigned page No. 803, in book No. \_\_\_\_\_

Eleanor Vaughan County Official  
Cross Index No. Q-3 T. 35N R. 27W M.