

CERTIFIED LAND CORNER RECORDATION
(REFERENCE FSM 7153-53)

DESCRIPTION OF CORNER EVIDENCE FOUND, AND ORIGINAL RECORD (IF KNOWN)

At the SW 1/16 corner of Section 29, T35N, R27W, Lincoln County, Montana:

NO ORIGINAL EVIDENCE

DESCRIPTION OF MONUMENT AND ACCESSORIES ESTABLISHED
TO PERPETUATE THE ORIGINAL LOCATION OF THIS CORNER:

Date of work: April, 1980

At the corner a 3- $\frac{1}{4}$ " alum. cap on a 2"x30" pipe was set 24" in the ground with a mound of stone. The following RM's were set:

An 18" fir bears S.26°E., 70.9 feet
A 12" fir bears N.81 $\frac{1}{2}$ °W., 30.5 feet

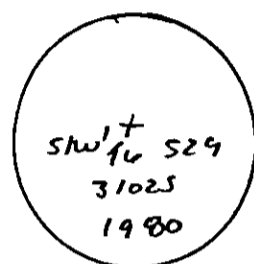

Variance: 19-3/4°

SKETCH, WITH COURSE AND DISTANCE TO ADJACENT CORNERS IF DETERMINED IN THIS SURVEY.
(MAY SKETCH OR PASTE REPRODUCTION ON REVERSE SIDE.)

See Certificate of Survey Number _____

Surveyor's Seal

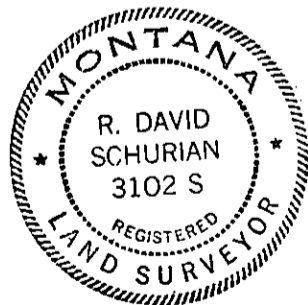

I, Paul S. Long, Jr.
certify that the information shown herein is true and correct.

Paul S. Long, Jr.

Signature of Ground Party Chief

I, R. David Schurian
certify that I have carefully performed or reviewed the work done on the diagrammed corner as reported on this recordation form and approve the same.

R. David Schurian

Signature of Surveyor

DIAGRAM OF CORNER:

T35N, R27W
SECTION 29

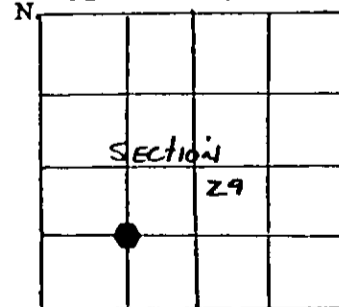

= Corner recorded on the sheet

3102S

Registration Number

Office of Clerk and Recorder, County of Lincoln

This "corner record" was filed for record on the 24th day of June, 1980, was noted on the cross-index plat and assigned page No. 801, in book No. _____

Elmer L. Vaughan by Sharon M. Winkholz
County Official

Cross Index No. U-8 T. 35N R. 27W Me