

CERTIFIED LAND CORNER RECORDATION
(REFERENCE FSM 7153.53)

DESCRIPTION OF CORNER EVIDENCE FOUND, AND ORIGINAL RECORD (IF KNOWN)

At the C-E-SE 1/64 corner of Section 19, T35N, R27W, Lincoln County, Montana:

NO ORIGINAL EVIDENCE

DESCRIPTION OF MONUMENT AND ACCESSORIES ESTABLISHED
TO PERPETUATE THE ORIGINAL LOCATION OF THIS CORNER:

Date of work: April, 1980

At the corner a 3-1/4" alum. cap was set on a 2"x30" pipe,
22" in the ground with a mound of stone. The following RM's
were set:

A 7" fir bears S.27 1/2°E., 15.2 feet
A 10" larch bears S.45°W., 21.4 feet

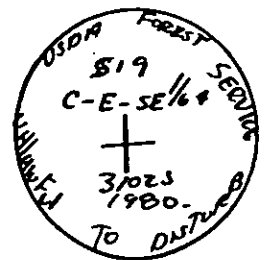

Variance: 19-3/4°

SKETCH, WITH COURSE AND DISTANCE TO ADJACENT CORNERS IF DETERMINED IN THIS SURVEY.
(MAY SKETCH OR PASTE REPRODUCTION ON REVERSE SIDE.)

See Certificate of Survey Number _____

Surveyor's Seal

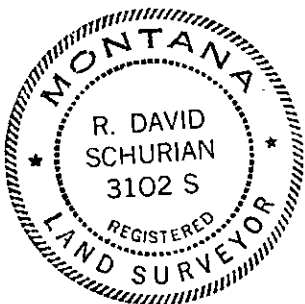

I, Paul S. Long, Jr.
certify that the information shown herein is true and
correct.

Paul S. Long, Jr.

Signature of Ground Party Chief

I, R. David Schurian
certify that I have carefully performed or reviewed the
work done on the diagrammed corner as reported on this
recordation form and approve the same.

R. David Schurian

Signature of Surveyor

DIAGRAM OF CORNER:

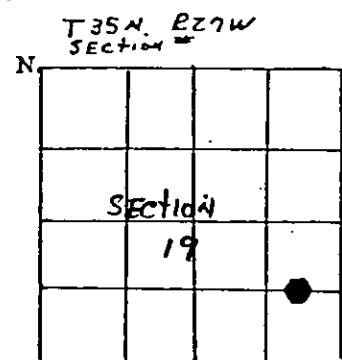

= Corner recorded on the sheet

3102S

Registration Number

Office of Clerk and Recorder, County of Lincoln

This "corner record" was filed for record on the 24th day of June, 1980, was noted on the cross-index plat and is
assigned page No. 799, in book No. _____

Eleanor L. Vaughn by Shawn M. Wexler
County Official Deputy

Cross Index No. Q-4-5 T. 35N R. 27W Mer.