

CERTIFIED LAND CORNER RECORDATION  
(REFERENCE FSM 7153.53)

DESCRIPTION OF CORNER EVIDENCE FOUND, AND ORIGINAL RECORD (IF KNOWN)

At the C-S 1/16 Corner of Section 30, T35N, R27W, Lincoln County, Montana:

NO EVIDENCE

DESCRIPTION OF MONUMENT AND ACCESSORIES ESTABLISHED  
TO PERPETUATE THE ORIGINAL LOCATION OF THIS CORNER:

Date of work: April, 1980

Set a 30 1/2" alum. cap on a 2" x 30" pipe, 24" in the ground  
w/small mound of stone. Set the following RM's:

A 12" fir bears N.48 1/2° E., 21.9 feet  
A 14" fir bears N.72 1/2° W., 15.7 feet

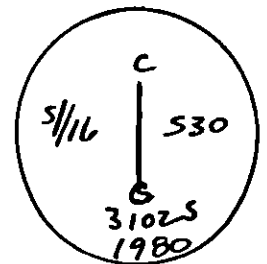

Variance: 19-3/4°

SKETCH, WITH COURSE AND DISTANCE TO ADJACENT CORNERS IF DETERMINED IN THIS SURVEY.  
(MAY SKETCH OR PASTE REPRODUCTION ON REVERSE SIDE.)

See Certificate of Survey Number \_\_\_\_\_

Surveyor's Seal



I, Paul S. Long, Jr.  
certify that the information shown herein is true and correct.

*Paul S. Long, Jr.*  
Signature of Ground Party Chief

I, R. David Schurian  
certify that I have carefully performed or reviewed the  
work done on the diagrammed corner as reported on this  
recording form and approve the same.

*R. David Schurian*  
Signature of Surveyor

DIAGRAM OF CORNER:

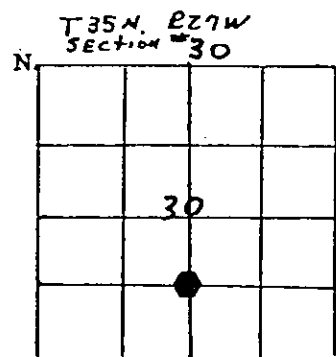

= Corner recorded on the sheet

3102S  
Registration Number

Office of Clerk and Recorder, County of Lincoln

This "corner record" was filed for record on the 24<sup>th</sup> day of June 1980, was noted on the cross-index plat and is  
assigned page No. 795, in book No. \_\_\_\_\_

*Elaine J. Vaughn by Sheri M. Winkler*  
County Official Deputy

Cross Index No. U-3 T. 35N R. 27W Mer.