

CERTIFIED LAND CORNER RECORDATION
(REFERENCE FSM 7153.53)

DESCRIPTION OF CORNER EVIDENCE FOUND, AND ORIGINAL RECORD (IF KNOWN)

At the section corners common to Sections 13 18 , T35N, R27W, Lincoln County, Montana,
24 19 , R28W

ORIGINAL RECORD: A limestone 16x12x5, 11" in the ground; 3 grooves on South & 3 grooves on the North face, from which:

- A 13" fir bears N.14°E., 20.46 feet
- A 12" fir bears S.58°E., 23.10 feet
- A 16" fir bears S.65½°W., 16.60 feet
- A 12" fir bears N.38½°W., 38.28 feet

FOUND: See below

DESCRIPTION OF MONUMENT AND ACCESSORIES ESTABLISHED TO PERPETUATE THE ORIGINAL LOCATION OF THIS CORNER:

Date of work: 11/17/79

Found at this corner a 3-½" BLM brass cap on a 2-½" galv. iron pipe, from which:

- A 16" fir bears N.17°E., 22.4 feet
- An 8" fir bears S.27°E., 53.7 feet
- An 18" fir bears S.66°W., 36.6 feet (Orig. BT appears to be a dist. bust from GLO Record 16.6 feet)
- A 6" fir bears N.25°W., 20.0 feet

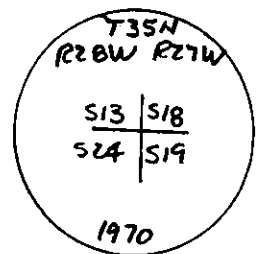

Variance: 21°

SKETCH, WITH COURSE AND DISTANCE TO ADJACENT CORNERS IF DETERMINED IN THIS SURVEY. (MAY SKETCH OR PASTE REPRODUCTION ON REVERSE SIDE.)

Surveyor's Seal

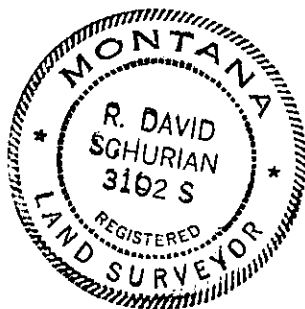

I, Paul A. Long,
certify that the information shown herein is true and correct.

Paul A. Long
Signature of Ground Party Chief

R. David Schurian
I, _____
certify that I have carefully performed or reviewed the work done on the diagrammed corner as reported on this recordation form and approve the same.

R. David Schurian
Signature of Surveyor

3102S
Registration Number

DIAGRAM OF CORNER:

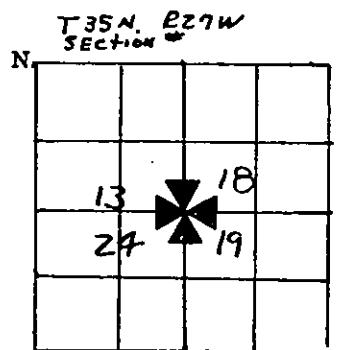

= Corner recorded on the sheet

Office of Clerk and Recorder, County of Lincoln

This "corner record" was filed for record on the 24th day of June, 1980, was noted on the cross-index plat and is assigned page No. 291, in book No. _____

Edward J. Vaughn by Sharon M. Wenzel
County Official Deputy

Cross Index No. N-1 T 35N R 27W Mer.
N-25 T 35N R 28W