

CERTIFIED LAND CORNER RECORDATION
(REFERENCE FSM 7153.53)

DESCRIPTION OF CORNER EVIDENCE FOUND, AND ORIGINAL RECORD (IF KNOWN)

At the 1/4 corner common to Sections $\frac{18}{19}$, T35N, R27W, Lincoln County, Montana:

ORIGINAL RECORD: A fir post 3 ft. long, 4" square, 24" in the ground marked S18 on North and S19 on the South, from which:

- An 8" spruce bears N.31°E., 9.90 feet
- An 8" pine bears S.49-1/4°W., 11.88 feet

FOUND: See below

DESCRIPTION OF MONUMENT AND ACCESSORIES ESTABLISHED TO PERPETUATE THE ORIGINAL LOCATION OF THIS CORNER:

Date of work: April, 1980

Corner is a single proportion. Not enough evidence could be found to reestablish old corner. 2-1/2" brass cap on a 2" x 30" pipe, the following RM's were set:

- A 7" larch bears N.51 1/2°E., 3.2 feet
- A 7" larch bears S.28°E., 4.3 feet

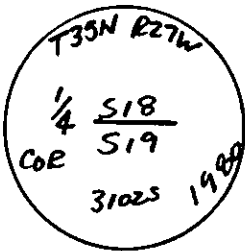

Variance: 19-3/4°

SKETCH, WITH COURSE AND DISTANCE TO ADJACENT CORNERS IF DETERMINED IN THIS SURVEY. (MAY SKETCH OR PASTE REPRODUCTION ON REVERSE SIDE.)

See Certificate of Survey Number _____

Surveyor's Seal

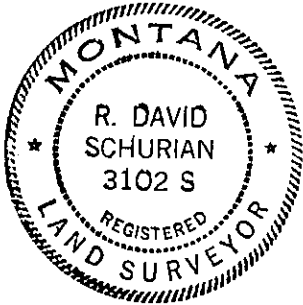

I, Paul S. Long, Jr. certify that the information shown herein is true and correct.

Paul S. Long, Jr.
Signature of Ground Party Chief

I, R. David Schurian certify that I have carefully performed or reviewed the work done on the diagrammed corner as reported on this recordation form and approve the same.

R. David Schurian
Signature of Surveyor

3102S
Registration Number

DIAGRAM OF CORNER:

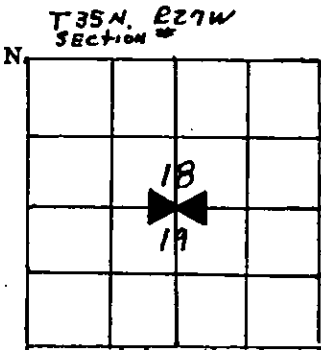

= Corner recorded on the sheet

Office of Clerk and Recorder, County of Lincoln

This "corner record" was filed for record on the 24th day of June 1980, was noted on the cross-index plat and is assigned page No. 288, in book No. _____

Edward J. Vaughn by Sharon M. Wierbocky
County Official Deputy

Cross Index No. N-3 T. 35N R. 27W Mer.