

CERTIFIED LAND CORNER RECORDATION
(REFERENCE FSM 7153.53)

DESCRIPTION OF CORNER EVIDENCE FOUND, AND ORIGINAL RECORD (IF KNOWN)

At the 1/4 corner common to Sections 19 20, T35N, R.27W, Lincoln County, Montana,

ORIGINAL RECORD: A limestone 15x12x6", 10" in the ground with 1/4 marked on West face, from which:
A 40" tamarack bears S.46 1/4°E., 18.48 feet
A 5" tamarack bears S.18°W., 3.30 feet

FOUND: See below

DESCRIPTION OF MONUMENT AND ACCESSORIES ESTABLISHED TO PERPETUATE THE ORIGINAL LOCATION OF THIS CORNER:

Date of work: 12/9/79

Found at this corner a 3-1/4" BLM brass cap on a 2" pipe, from which:

A 17" larch bears S.24 1/4°E., 14.3 feet
An 8" larch bears S.72 1/4°W., 17.00 feet

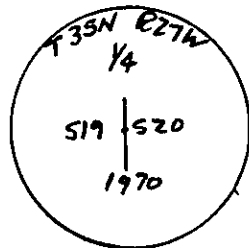

Variance: 21°

SKETCH, WITH COURSE AND DISTANCE TO ADJACENT CORNERS IF DETERMINED IN THIS SURVEY.
(MAY SKETCH OR PASTE REPRODUCTION ON REVERSE SIDE.)

See Certificate of Survey No. _____.

Surveyor's Seal

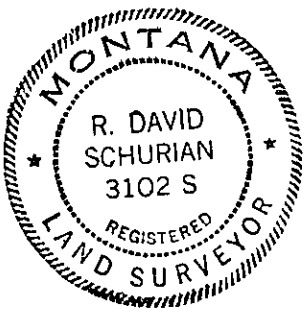

I, Paul S. Long, Jr.
certify that the information shown herein is true and correct.

Paul S. Long Jr.
Signature of Ground Party Chief

I, R. DAVID SCHURIAN
certify that I have carefully performed or reviewed the work done on the diagrammed corner as reported on this recordation form and approve the same.

R. David Schurian
Signature of Surveyor

3102S
Registration Number

DIAGRAM OF CORNER:

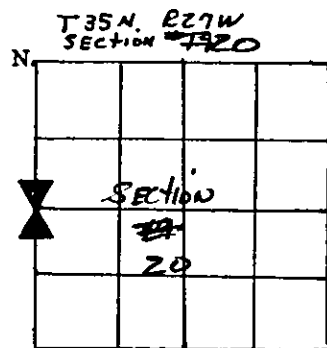

= Corner recorded on the sheet

Office of Clerk and Recorder, County of Lincoln

This "corner record" was filed for record on the 24th day of June 1980, was noted on the cross-index plat and is assigned page No. 779, in book No. _____

Eleanor S. Vaughn
County Official

Cross Index No. P-5 T. 35N R. 27W Mer.