

CERTIFIED LAND CORNER RECORDATION
(REFERENCE FSM 7153.53)

DESCRIPTION OF CORNER EVIDENCE FOUND, AND ORIGINAL RECORD (IF KNOWN)

At the 1/4 corner common to Sections 25, 30, T35N, R27W
R28W, Lincoln County, Montana,

ORIGINAL RECORD: A slate stone 16x12x7", 11" in the ground, 1/4 COR: marked on West face,
from which:
A 4" willow bears S.57°E., 11.22 feet
A 26" larch bears S.85°W., 56.10 feet

FOUND: See below

DESCRIPTION OF MONUMENT AND ACCESSORIES ESTABLISHED
TO PERPETUATE THE ORIGINAL LOCATION OF THIS CORNER:

Date of work: 12/10/79

Found at this corner a 3-1/4" BLM brass cap on a 2" pipe, 6" out of ground,
from which:

An 8" larch bears N.83°E., 12.5 feet
A 10" larch bears S.76°W., 38.7 feet

Variance: 21°

SKETCH, WITH COURSE AND DISTANCE TO ADJACENT CORNERS IF DETERMINED IN THIS SURVEY.
(MAY SKETCH OR PASTE REPRODUCTION ON REVERSE SIDE.)

See Certificate of Survey No. _____.

Surveyor's Seal

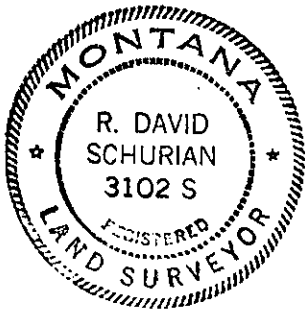

Paul S. Long, Jr.

I, _____
certify that the information shown herein is true and correct.

Paul S. Long, Jr.
Signature of Ground Party Chief

I, R. DAVID SCHURIAN
certify that I have carefully performed or reviewed the
work done on the diagrammed corner as reported on this
recordation form and approve the same.

R. David Schurian
Signature of Surveyor

3102S
Registration Number

DIAGRAM OF CORNER:

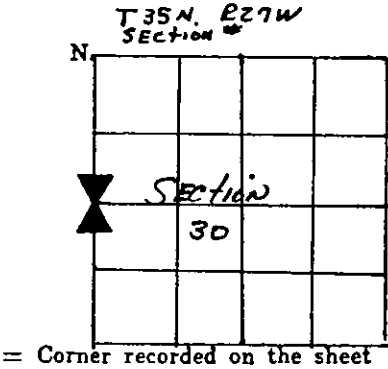

Office of Clerk and Recorder, County of Lincoln

This "corner record" was filed for record on the 24th day of June 1980, was noted on the cross-index plat and is
assigned page No. 778, in book No. _____

Eleanor L. Vaughn, Sharon M. Wenzel
County Official

Cross Index No. T-1 T-35N R-27W Mer.
T-25 35N 28W