

CERTIFIED LAND CORNER RECORDATION
(REFERENCE FSM 7153.53)

DESCRIPTION OF CORNER EVIDENCE FOUND, AND ORIGINAL RECORD (IF KNOWN)

At the 1/4 corner common to Sections $\frac{20}{29}$, T35N, R27W, Lincoln County, Montana,

ORIGINAL: A limestone 15x10x6", 10" in the ground, with 1/4 marked on North face,
RECORD: from which:

- A 12" fir bears N.52-3/4°E., 12.54 feet
- A 10" fir bears S.33 1/4°W., 24.42 feet

FOUND: See below

DESCRIPTION OF MONUMENT AND ACCESSORIES ESTABLISHED
TO PERPETUATE THE ORIGINAL LOCATION OF THIS CORNER:

Date of work: 12/6/79

Found at this corner a 3-1/4" BLM brass cap on a 2" pipe and mound of stone,
from which:

- A 14" fir bears N.56 1/4°E., 12.3 feet (Old BT)
- A 6" fir bears S.02°W., 35.9 feet
- A 13" fir bears S.34°W., 24.00 feet (Old BT)

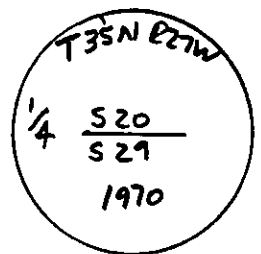

Variance: 21°

SKETCH, WITH COURSE AND DISTANCE TO ADJACENT CORNERS IF DETERMINED IN THIS SURVEY.
(MAY SKETCH OR PASTE REPRODUCTION ON REVERSE SIDE.)

See Certificate of Survey No. _____

Surveyor's Seal

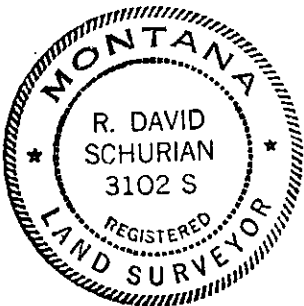

Paul S. Long, Jr.

I, _____
certify that the information shown herein is true and correct.

Paul S. Long, Jr.
Signature of Ground Party Chief

I, R. DAVID SCHURIAN
certify that I have carefully performed or reviewed the work done on the diagrammed corner as reported on this recordation form and approve the same.

R. David Schurian
Signature of Surveyor

DIAGRAM OF CORNER:

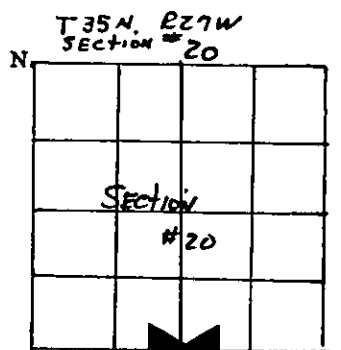

= Corner recorded on the sheet

3102S
Registration Number

Office of Clerk and Recorder, County of *Lincoln*

This "corner record" was filed for record on the *24th* day of *June*, 19*80*, was noted on the cross-index plat and is

assigned page No. *776*, in book No. _____

Eleanor F. Vaughn
County Official

Cross Index No. *R-7* T. *35N* R. *27W* Mer.