

INSTRUCTIONS

1. Original and/or subsequent record used to evaluate the corner position.
2. Description of evidence found, note discrepancies in the record, state method of establishing lost or obliterated corners.
3. Description of monument and accessories set to perpetuate the corner position.
4. Sketch of corner, show all pertinent data which can best be shown in a sketch example, corner marking, topography ties, position of accessories, etc.
5. Certification must be signed and sealed by Land Surveyor registered in the State of Montana.
6. Fill in Cross Index & Section Diagram at bottom of sheet.

CERTIFIED CORNER RECORDATION

Corner 6 of HES 573 T. 35 N. R. 27 W. P.M.M. Lincoln County

I. 1919 HES 573 record by W. P. Stephenson: "Establish for Cor. No. 6 of this survey as follows:

Set a small stone marked with a cross(x), under a slate stone, 24x10x3 ins., 14 ins. in the ground, mkd. 6 HES 573 on the NE face, and a cross(x) on top for the exact corner point, from which

A cross(X) on a pine, 4 ins. diam., bears N69°17'E, 63 lks.(41.58 ft.) dist.
 A cross(X) on a pine, 4 ins. diam., bears S8°18'W, 21 lks.(13.86 ft.) dist.
 Each blaze and scribed 6 HES 573 BT.

Raise a mound of earth 4 ft. base, 2 ft. high, East of the corner."

II. Found a firmly set 24x10x3 ins. stone, 6 ins. out of the ground, mkd. 6 HES 573 on NE face.

From which:

A fir, 12 ins. diam., bears S36°E, 23.2 ft. dist., visible scribing.(No record)
 A fir, 12 ins. diam., bears N30°W, 17.3 ft. dist., healed face.(No record)

No evidence of original Bearing Trees were found.

III. Painted red bands around the bearing trees and attached "Land Survey Monument" and "Bearing Tree" signs.

Carsonite post with Land Survey Monument and Property Boundary decals attached bears S45°E, 1.5 feet.

Magnetic declination: 20° East

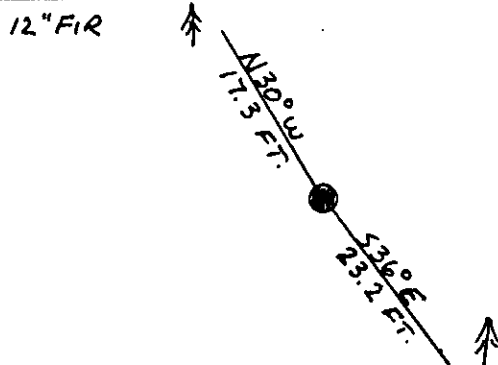

SKETCH OF CORNER

CERTIFICATION
Kenneth Kern

I, _____
 certify the information shown herein is true and correct.

Kenneth R Kern
 Signature Ground Party Chief
 Alvah F. Hughes

I, _____
 certify that this Corner Record correctly represents work performed by me or under my direction in compliance with the "Corner Recordation Act" (70-22-101, et seq., M.C.A.)

Alvah F. Hughes
 1/12/92 Signature of Surveyor & Seal
 7322LS HUGHES

Date: _____ Reg. No. _____
 U.S. FOREST SERVICE
 Employer: _____

Office of Clerk and Recorder, County of Lincoln. This "corner record" was filed for record on Jan 28, 1992 was noted on the cross-index plat and is assigned page No. 4680, in book No. _____ Coral M Cummings by Lois Beckhoff

County Official
 6 HES 573 35 N 27 W

Cross Index No. _____ T. _____ R. _____ PMM

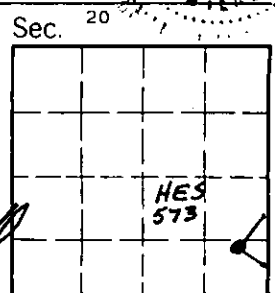

• corner this sheet