

INSTRUCTIONS

1. Original and/or subsequent record used to evaluate the corner position.
2. Description of evidence found, note discrepancies in the record, state method of establishing lost or obliterated corners.
3. Description of monument and accessories set to perpetuate the corner position.
4. Sketch of corner, show all pertinent data which can best be shown in a sketch example, corner marking, topography ties, position of accessories, etc.
5. Certification must be signed and sealed by Land Surveyor registered in the State of Montana.
6. Fill in Cross Index & Section Diagram at bottom of sheet.

CERTIFIED CORNER RECORDATION

Corner 3 of HES 573 T. 35 N. R. 27 W. P.M.M. Lincoln County

- I. 1919 HES 573 record by W. P. Stephenson: "Established Cor. No. 3 of this survey as follows:
Set a small stone marked with a cross(x), under an iron post, 2 ins. diam., 36 ins. long, 24 ins. in the ground, with a brass cap marked 3 HES 573 1919 and a point on top for the exact corner point, from which
- A cross(X) on a pine, 7 ins. diam., bears N18°53'E, 39 lks.(25.74 ft.) dist.
A cross(X) on a spruce, 18 ins. diam., bears N18°17'W, 18 lks.(11.88 ft.) dist.
Each blaze and scribed 3 HES 573 BT.

Raise a mound of earth, 4 ft. base, 2 ft. high, North of the corner.

- II. Found a 2 ins. diam. iron pipe, 8 ins. out of the ground, with USPS brass cap mkd. as shown.

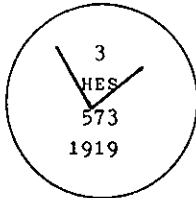

From which:

- A spruce, 10 ins. diam., bears N68°E, 20.1 ft. dist., visible scribing.(No record)
A fir, 12 ins. diam., bears S20°W, 25.9 ft. dist., visible scribing.(No record)

- III. Painted red bands around the bearing trees and attached "Land Survey Monument" and "Bearing Tree" signs.
Set a galvanized steel guard post with "Land Survey Marker" and "Property Boundary" decals, N45°W, 3 ft.
Magnetic declination: 20° East

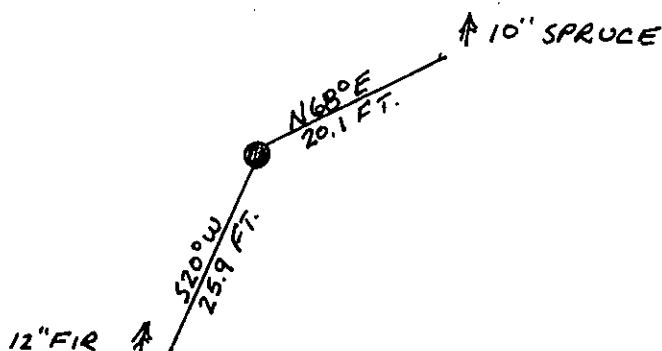

SKETCH OF CORNER

CERTIFICATION
Kenneth Kern

I, _____
certify the information shown herein is true and correct.

Kenneth R Kern
Signature Ground Party Chief
Alvah F. Hughes

I, _____
certify that this Corner Record correctly represents work performed
by me or under my direction in compliance with the "Corner
Recordation Act" (70-22-101, et seq., M.C.A.)

Alvah F. Hughes
Signature of Surveyor & Seal
1/12/92 7322LS

Date: _____ Reg. No. _____
U.S. FOREST SERVICE

Employer: _____

Office of Clerk and Recorder, County of Lincoln. This "corner
record" was filed for record on Jan 28, 1992
was noted on the cross-index plat and is assigned page No. 4677, in
book No. _____ Coral M Cummings by Div Beechell

County Official
3 HES 573 35 N 27 W

Cross Index No. _____ T. _____ R. _____ PMM

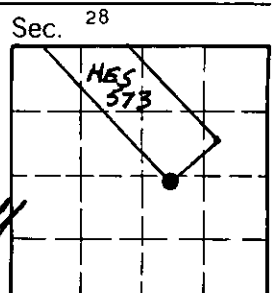

• - corner this sheet