

INSTRUCTIONS

1. Original and/or subsequent record used to evaluate the corner position.
2. Description of evidence found, note discrepancies in the record, state method of establishing lost or obliterated corners.
3. Description of monument and accessories set to perpetuate the corner position.
4. Sketch of corner, show all pertinent data which can best be shown in a sketch example, corner marking, topography ties, position of accessories, etc.
5. Certification must be signed and sealed by Land Surveyor registered in the State of Montana.
6. Fill in Cross Index & Section Diagram at bottom of sheet.

CERTIFIED CORNER RECORDATION

Corner 3 of HES 332 T. 35 N. R. 27 W. P.M.M. Lincoln County

- I. 1915 H.E.S. original record by Elmer R. Johnson: Set a stone monument with two bearing trees and a mound of earth.

1961 B.L.M. remonumentation by David R. Cunningham et al: "Cor. No. 3 of Homestead Entry Survey No. 332, monumented with a slate stone, 24x15x10 ins., firmly set and mkd. 3 HES 332 on the NE face, and witnessed by the remains of the original bearing trees.

At the corner point, set an iron post, 30 ins. long, 2 1/2 ins. diam., 28 ins. in the ground, in concrete, with brass cap mkd.

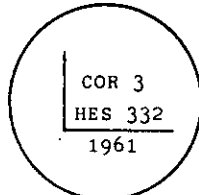

from which

The remains of the original bearing trees:

A fir, 14 ins. diam., bears N50 1/2° E, 11 lks. dist., mkd. 3 HES 332 BT.

(Record: N47° 35' E, 11 lks.)

A dead larch, 8 ins. diam., bears S47° E, 22 lks. dist., mkd. 3 HES 332 BT.

(Record: S50 1/4° E, 22 lks.)

The new bearing trees:

A fir, 6 ins. diam., bears S75 1/2° W, 18 lks. dist., mkd. COR 3 HES 332 BT.

Bury the original stone alongside of the iron post."

- II. Found a 2 1/2 ins. diam. pipe, 2 ins. out of the ground, with BLM brass cap mkd. as shown, from which
- A dead douglas fir, 14 ins. diam., bears N50° 30' E, 7.3 ft. (11 lks.) dist., visible scribe.
 - A dead and down larch, 8 ins. diam., bears S47° E, 14.5 ft. (22 lks.) dist., visible scribe.
 - A douglas fir, 10 ins. diam., bears S75° 30' W, 11.9 ft. (18 lks.) dist., invisible scribe.

- III. Established one new bearing tree

A douglas fir, 4 ins. diam., bears S34° E, 7.4 ft. dist., mkd. X BT.

Painted red bands around the bearing trees and attached Land Survey Monument and Bearing Tree signs.

Set a 6 ft. galvanized steel guard post with Land Survey Marker and Property Boundary decals.

North, 4 ft.

Magnetic declination: 20° East.

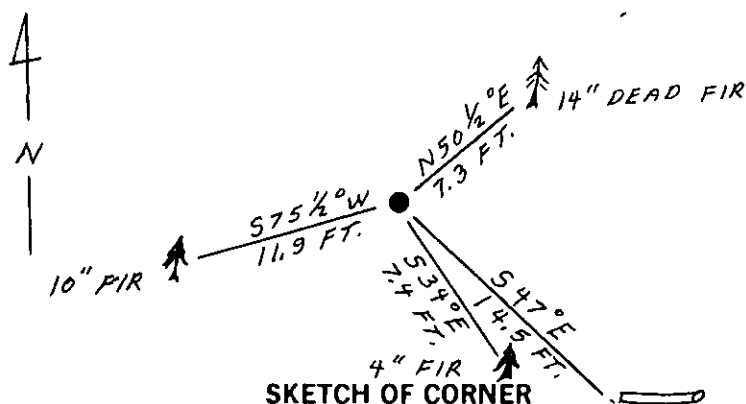

CERTIFICATION

Kenneth Kern

I, Kenneth Kern certify the information shown herein is true and correct.

Signature Ground Party Chief

Alvah F. Hughes

I, Alvah F. Hughes certify that this Corner Record correctly represents work performed by me or under my direction in compliance with the "Corner Recordation Act" (70-22-101, et seq., M.C.A.).

Signature of Surveyor & Seal

8/6/91

Date: 8/6/91 Reg. No. 7327 LS

Employer: U.S. FOREST SERVICE

Office of Clerk and Recorder, County of Lincoln. This "corner

record" was filed for record on Sept 16, 1991

was noted on the cross-index plat and is assigned page No. 4587, in

book No.

Coral M. Cummings by Bill Buckoff
County Official

Cross Index No. 3 HES 332 T. 35 N. R. 27 W. P.M.M.

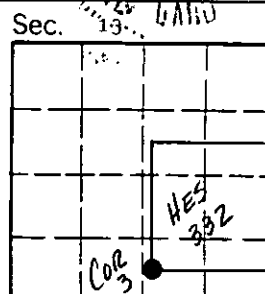

• - corner this sheet