

INSTRUCTIONS

1. Original and/or subsequent record used to evaluate the corner position.
2. Description of evidence found, note discrepancies in the record, state method of establishing lost or obliterated corners.
3. Description of monument and accessories set to perpetuate the corner position.
4. Sketch of corner, show all pertinent data which can best be shown in a sketch example, corner marking, topography ties, position of accessories, etc.
5. Certification must be signed and sealed by Land Surveyor registered in the State of Montana.
6. Fill in Cross Index & Section Diagram at bottom of sheet.

CERTIFIED CORNER RECORDATION

Corner 1/4 of Secs. 13 and 14 T. 35 N. R. 27 W. P.M.M. Lincoln County

- I. 1913 G.L.O. original record by L. Lyman et al: Set a stone monument with two bearing trees.

1967 BLM remonumentation by Woodrow E. Damm et al: "The 1/4 sec. cor. of secs. 13 and 14, as determined from the original NW bearing tree.

At the corner point, set an iron post, 30 ins. long, 2 1/2 ins. diam., 24 ins. in the ground, in concrete, with brass cap mkd.

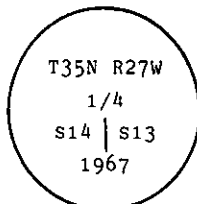

from which

The original bearing tree:

A tamarack, 12 ins. diam., bears N47 1/2° W, 95 lks. dist., mkd. 1/4 S14 BT. (Record)

The new bearing trees:

A larch, 6 ins. diam., bears S78 1/2° E, 11 lks. dist., mkd. 1/4 S13 BT.

A fir, 8 ins. diam., bears S73 1/2° W, 85 lks. dist., mkd. 1/4 S14 BT.

- II. Found a 2 1/2 ins. diam. pipe, 6 ins. out of the ground, with BLM brass cap mkd. as shown, from which

A larch, 10 ins. diam., bears S78° E, 7.2 ft. (11 lks.) dist., no visible scribing.

A douglas fir, 10 ins. diam., bears S76° W, 56.1 ft. (85 lks.) dist., no visible scribing.

A larch, 16 ins. diam., bears N47° W, 62.6 ft. (95 lks.) dist., mkd. 1/4 S14 BT.

- III. Painted red bands around the bearing trees and attached Land Survey Monument and Bearing Tree signs.

Set a 6 ft. galvanized steel guard post with Land Survey Marker and Property Boundary decals, North, 6 ft.

Magnetic Declination: 20° East

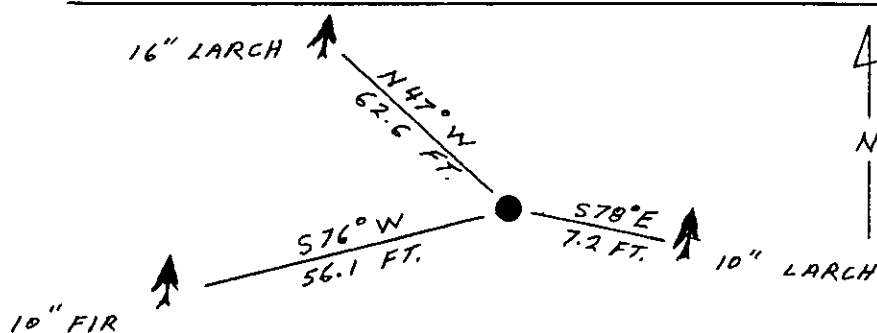

SKETCH OF CORNER

CERTIFICATION

- I. Steve Boyer
certify the information shown herein is true and correct.

Steve A. Boyer
Signature Ground Party Chief

- I. Alvah F. Hughes
certify that this Corner Record correctly represents work performed by me or under my direction in compliance with the "Corner Recordation Act" (70-22-101, et seq., M.C.A.)

Alvah F. Hughes
Signature of Surveyor

Date: 8/6/91 Reg. No. 7322

Employer: U.S. FOREST SERVICE

Office of Clerk and Recorder, County of Lincoln. This "corner record" was filed for record on Sept 16, 1991

was noted on the cross-index plat and is assigned page No. 4582, in

book No. _____

Coral M. Cummings by Bill Blackoff
County Official

Sec. 13

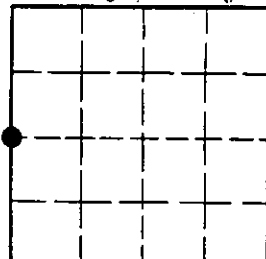

• - corner this sheet

Cross Index No. L-21 T. 35 N. R. 27 W. P.M.M.