

## INSTRUCTIONS

1. Original and/or subsequent record used to evaluate the corner position.
2. Description of monument found, note discrepancies in the record, state method of re-establishing lost or obliterated corners.
3. Description of monument and accessories set to perpetuate the corner position.
4. Sketch of corner, show all pertinent data which can best be shown in a sketch example, corner marking, topography ties, position of accessories, etc.
5. Certification must be signed and sealed by Registered Land Surveyor in State of Montana.
6. Fill in Cross Index & Section Diagram at bottom of sheet.

## CERTIFIED CORNER RECORDATION

Corner Closing Corner Sec. 2 and 3 T. 35 N. R. 27 W. P.M.M. Lincoln County

## ORIGINAL RECORD G.L.O. 1913

Set a limestone, 16x10x6 ins. 12 ins. in the ground, for closing cor. of secs. 2 and 3, mkd. CC on the S., with 2 grooves on the E. and 4 grooves on the W. face, from which:  
 A fir, 4 ins. dia., bears S 33 1/2° E, 79 lks. dist., mkd. T35N R27W S 2 BT.  
 A tamarack, 14 ins. dia., bears S 58 1/4° W, 78 lks. dist., mkd. T35N R27W S 3 BT.

## B.L.M. REMONUMENTATION 1960

The closing corner of secs. 2 and 3, monumented with a limestone, 10x8x6 ins., loosely set and mkd. CC on the S. face and with 2 notches on the E. and 4 notches on the W. edges, and witnessed by the original bearing trees.

At the corner point, Set an iron post, 30 ins. long, 2 1/2 ins. dia., 28 ins. in the ground, in concrete, with brass cap mkd.

T36N R27W from which the original bearing trees:

S 34

S 3 | S 2

T35N | R27W

C C

1960

A fir, 10 ins. dia., bears S 33 1/2° E, 79 lks. dist., mkd. T35N R27W S 2 BT.

A larch, 20 ins. dia., bears S 58 1/4° W, 78 lks. dist., mkd. T35N R27W S 3 BT.

Bury the original stone alongside and raise a mound of stone, 3 ft. base, 2 ft. high, S. of the iron post.

## EVIDENCE FOUND

Found a BLM brass cap, mkd. as shown above, from which:

A fir, 9 ins. dia., bears S 33 1/2° E, 52.8 ft. dist., with scribing visible. (GLO 1913 BT)

A larch, 16 ins. dia., bears S 58 1/4° W, 50.8 ft. dist., with scribing visible. (GLO 1913 BT)

Mound of stone S. of the brass cap.

## CORNER PERPETUATION

Set a galvanized steel post with a Survey Marker decal, 3 ft. North of the Brass cap. Painted red bands around the bearing trees and painted the scribing and blazing. Attached bearing tree signs and Land Survey Monument signs.

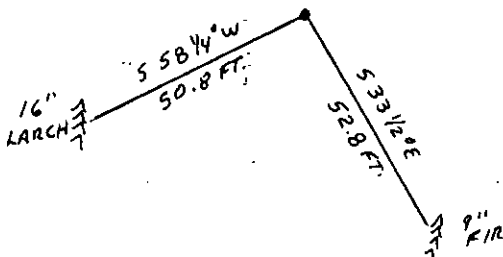

DECL. 21° E SKETCH OF CORNER

## CERTIFICATION

I, \_\_\_\_\_  
 certify the information shown herein is true and correct.

Signature Ground Party Chief

Philip A. Helps

I, \_\_\_\_\_  
 certify that this Corner Record correctly represents work performed by me or under my direction in compliance with the "Corner Recordation Act" (70-22-107, et seq., M.C.A.)

Signature of Surveyor & Seal

Date: 10/87 Reg. No. 4739 S

Employer: F & H Land Surveying, Whitefish

Office of Clerk and Recorder, County of Lincoln. This "corner record" was filed for record on the Nov. 30 day of 1987, was noted on the cross-index plat and is assigned page No. 3729, in book No. \_\_\_\_\_

County Official Janet B. Sugil by Sue Pauloff

Cross Index No. A - 17 T. 35 N R. 27 W PMM

Sec. 2			

• corner this sheet

1. The first part of the document is a letter from the

author to the editor of the journal, in which he expresses his

gratitude for the publication of his paper and for the

editor's kind and helpful comments.

2. The second part of the document is a letter from the

editor to the author, in which he expresses his

appreciation of the author's contribution to the journal and